

# StoPowerwall® DrainScreen™

Residential

Wood Frame Construction

Series 5.xx DS

October 2014

## ATTENTION

Sto products are intended for use by qualified professional contractors, not consumers, as a component of a larger construction assembly as specified by a qualified design professional, general contractor or builder. They should be installed in accordance with those specifications and Sto's instructions. Sto Corp. disclaims all, and assumes no, liability for on-site inspections, for its products applied improperly, or by unqualified persons or entities, or as part of an improperly designed or constructed building, for the nonperformance of adjacent building components or assemblies, or for other construction activities beyond Sto's control. Improper use of Sto products or use as part of an improperly designed or constructed larger assembly or building may result in serious damage to Sto products, and to the structure of the building or its components.

STO CORP. DISCLAIMS ALL WARRANTIES EXPRESSED OR IMPLIED EXCEPT FOR EXPLICIT LIMITED WRITTEN WARRANTIES ISSUED TO AND ACCEPTED BY BUILDING OWNERS IN ACCORDANCE WITH STO'S WARRANTY PROGRAMS WHICH ARE SUBJECT TO CHANGE FROM TIME TO TIME. For the fullest, most current information on proper application, clean-up, mixing and other specifications and warranties, cautions and disclaimers, please refer to the Sto Corp. website, [www.stocorp.com](http://www.stocorp.com).

[www.stocorp.com](http://www.stocorp.com)



Property of Sto Corp.  
All Rights Reserved.

# StoPowerwall® DrainScreen™ System Components

**Detail No.: 5.01 DS**

**Date: October 2014**

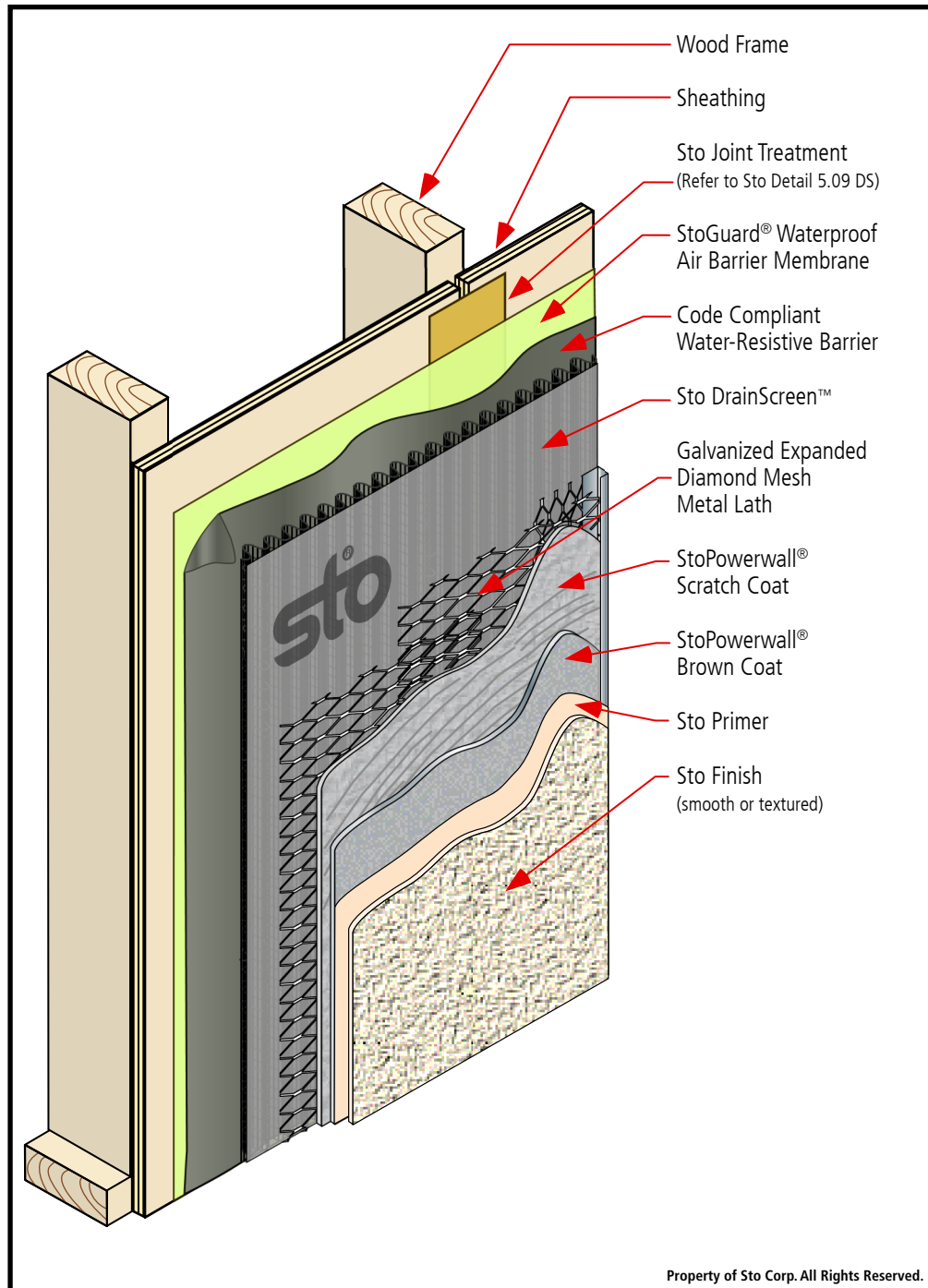

## **Notes:**

1. Detail shows the installation of StoPowerwall® DrainScreen™ over a wood frame wall.

## **Sto System Components:**

1. Sto joint treatment
2. StoGuard® Waterproof Air Barrier Membrane options:
  - a. Sto EmeraldCoat® (high perm)
  - b. StoGuard® VaporSeal™ (vapor impermeable)
3. Sto DrainScreen™
4. StoPowerwall® scratch coat
5. StoPowerwall® brown coat
6. Sto Primer
7. Sto Finish (smooth or textured)

## **Accessory Materials:**

(including means for fastening)

1. Galvanized expanded diamond mesh metal lath
2. Casing bead
3. Other accessories as may be required.  
(e.g. weep screeds, etc.)

IMPORTANT: Components not identified as Sto are furnished by other manufacturers and are not necessarily installed by trades who install the Sto products. Refer to project specific contract documents.

[www.stocorp.com](http://www.stocorp.com)

## **ATTENTION**

Sto products are intended for use by qualified professional contractors, not consumers, as a component of a larger construction assembly as specified by a qualified design professional, general contractor or builder. They should be installed in accordance with those specifications and Sto's instructions. Sto Corp. disclaims all, and assumes no, liability for on-site inspections, for its products applied improperly, or by unqualified persons or entities, or as part of an improperly designed or constructed building, for the nonperformance of adjacent building components or assemblies, or for other construction activities beyond Sto's control. Improper use of Sto products or use as part of an improperly designed or constructed larger assembly or building may result in serious damage to Sto products, and to the structure of the building or its components.

**STO CORP. DISCLAIMS ALL WARRANTIES EXPRESSED OR IMPLIED EXCEPT FOR EXPLICIT LIMITED WRITTEN WARRANTIES ISSUED TO AND ACCEPTED BY BUILDING OWNERS IN ACCORDANCE WITH STO'S WARRANTY PROGRAMS WHICH ARE SUBJECT TO CHANGE FROM TIME TO TIME.** For the fullest, most current information on proper application, clean-up, mixing and other specifications and warranties, cautions and disclaimers, please refer to the Sto Corp. website, [www.stocorp.com](http://www.stocorp.com).

# StoPowerwall® DrainScreen™ Deck Flashing

Detail No.: 5.32 DS

Date: October 2014

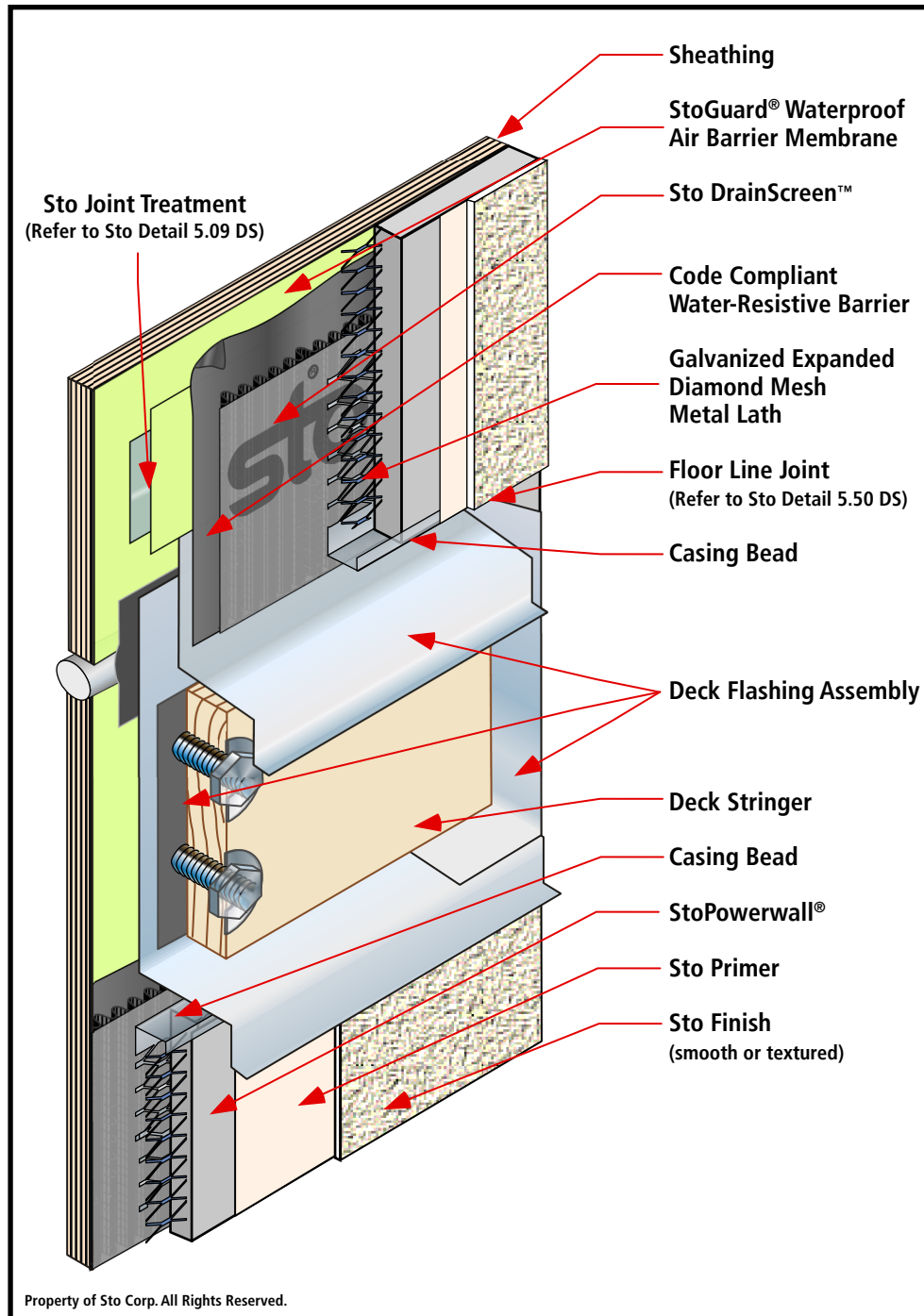

## Notes:

1. Install StoGuard® Waterproof Air Barrier Membrane on the sheathing as per plans and specifications.
2. Install deck flashing to divert water away from penetrations and to drain water to the exterior of the finished cladding.
3. Provide backer rod and sealant between the deck flashing assembly and the stucco casing beads installed around the vertical sides and sill

## Options:

StoGuard® Waterproof Air Barrier Membrane options:

- a. Sto EmeraldCoat® (high perm)
- b. StoGuard® VaporSeal™ (vapor impermeable)

IMPORTANT: Components not identified as Sto are furnished by other manufacturers and are not necessarily installed by trades who install the Sto products. Refer to project specific contract documents.

## ATTENTION

Sto products are intended for use by qualified professional contractors, not consumers, as a component of a larger construction assembly as specified by a qualified design professional, general contractor or builder. They should be installed in accordance with those specifications and Sto's instructions. Sto Corp. disclaims all, and assumes no, liability for on-site inspections, for its products applied improperly, or by unqualified persons or entities, or as part of an improperly designed or constructed building, for the nonperformance of adjacent building components or assemblies, or for other construction activities beyond Sto's control. Improper use of Sto products or use as part of an improperly designed or constructed larger assembly or building may result in serious damage to Sto products, and to the structure of the building or its components.

STO CORP. DISCLAIMS ALL WARRANTIES EXPRESSED OR IMPLIED EXCEPT FOR EXPLICIT LIMITED WRITTEN WARRANTIES ISSUED TO AND ACCEPTED BY BUILDING OWNERS IN ACCORDANCE WITH STO'S WARRANTY PROGRAMS WHICH ARE SUBJECT TO CHANGE FROM TIME TO TIME. For the fullest, most current information on proper application, clean-up, mixing and other specifications and warranties, cautions and disclaimers, please refer to the Sto Corp. website, [www.stocorp.com](http://www.stocorp.com).

[www.stocorp.com](http://www.stocorp.com)

# StoPowerwall® DrainScreen™ with Armor Guard System Components

Detail No.: 5.05 DS

Date: October 2014

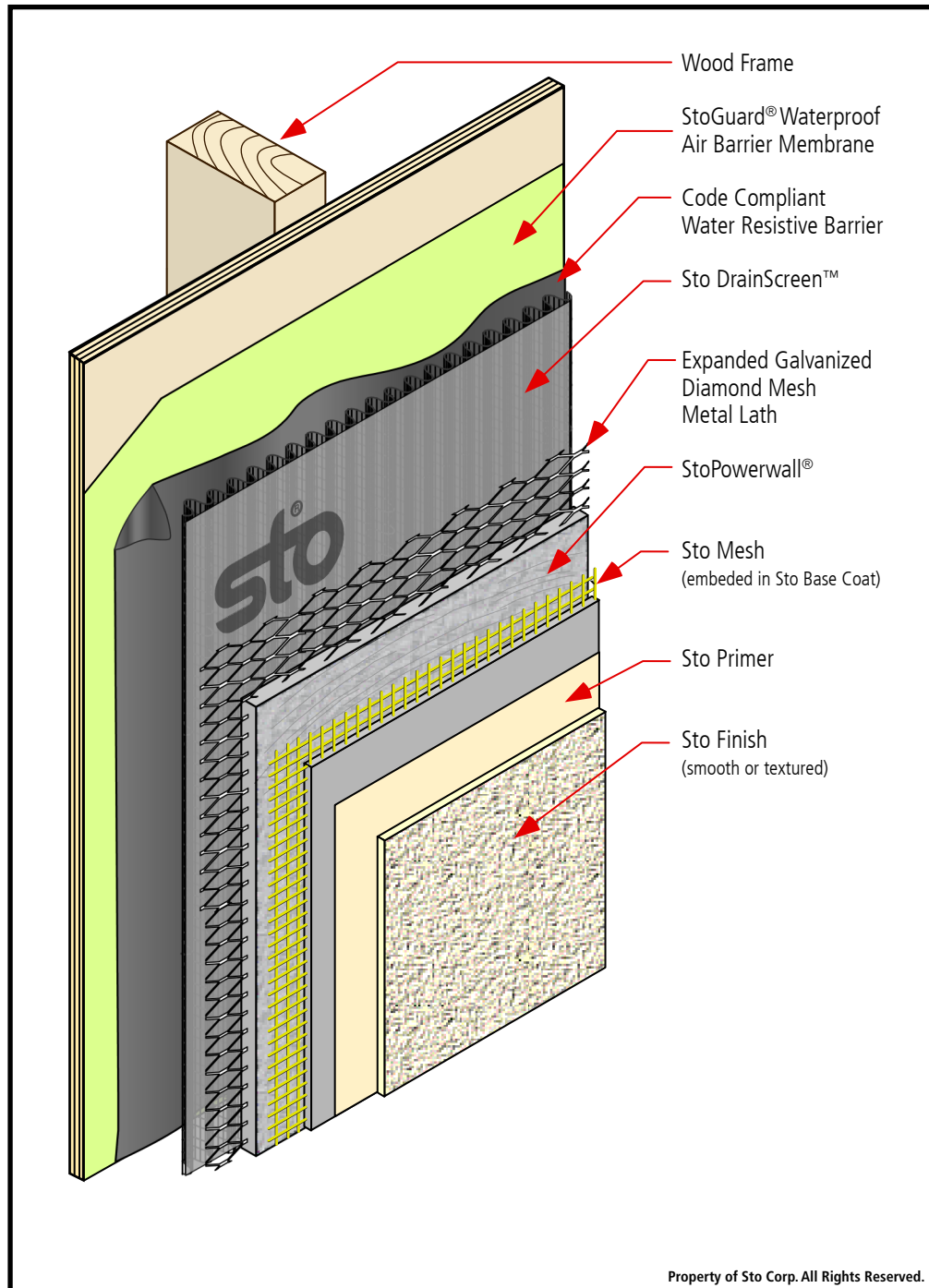

## Notes:

1. Detail shows the installation of StoPowerwall® DrainScreen™ with Armor Guard over a wood frame wall.

## Sto System Components:

1. StoGuard® Waterproof Air Barrier Membrane options:
  - a. Sto EmeraldCoat® (high perm)
  - b. StoGuard® VaporSeal™ (vapor impermeable)
2. Sto DrainScreen™
3. StoPowerwall®
4. Sto Mesh
5. Sto Base coat
6. Sto Primer
7. Sto Finish (smooth or textured)

## Accessory Materials:

(including means for fastening)

1. Galvanized expanded diamond mesh metal lath
2. Casing bead
3. Other accessories as may be required (e.g. weep screeds, etc.)

IMPORTANT: Components not identified as Sto are furnished by other manufacturers and are not necessarily installed by trades who install the Sto products. Refer to project specific contract documents.

[www.stocorp.com](http://www.stocorp.com)

## ATTENTION

Sto products are intended for use by qualified professional contractors, not consumers, as a component of a larger construction assembly as specified by a qualified design professional, general contractor or builder. They should be installed in accordance with those specifications and Sto's instructions. Sto Corp. disclaims all, and assumes no, liability for on-site inspections, for its products applied improperly, or by unqualified persons or entities, or as part of an improperly designed or constructed building, for the nonperformance of adjacent building components or assemblies, or for other construction activities beyond Sto's control. Improper use of Sto products or use as part of an improperly designed or constructed larger assembly or building may result in serious damage to Sto products, and to the structure of the building or its components.

STO CORP. DISCLAIMS ALL WARRANTIES EXPRESSED OR IMPLIED EXCEPT FOR EXPLICIT LIMITED WRITTEN WARRANTIES ISSUED TO AND ACCEPTED BY BUILDING OWNERS IN ACCORDANCE WITH STO'S WARRANTY PROGRAMS WHICH ARE SUBJECT TO CHANGE FROM TIME TO TIME. For the fullest, most current information on proper application, clean-up, mixing and other specifications and warranties, cautions and disclaimers, please refer to the Sto Corp. website, [www.stocorp.com](http://www.stocorp.com).

# StoPowerwall® with Armor Guard System Components

Detail No.: 5.06 E

Date: October 2014

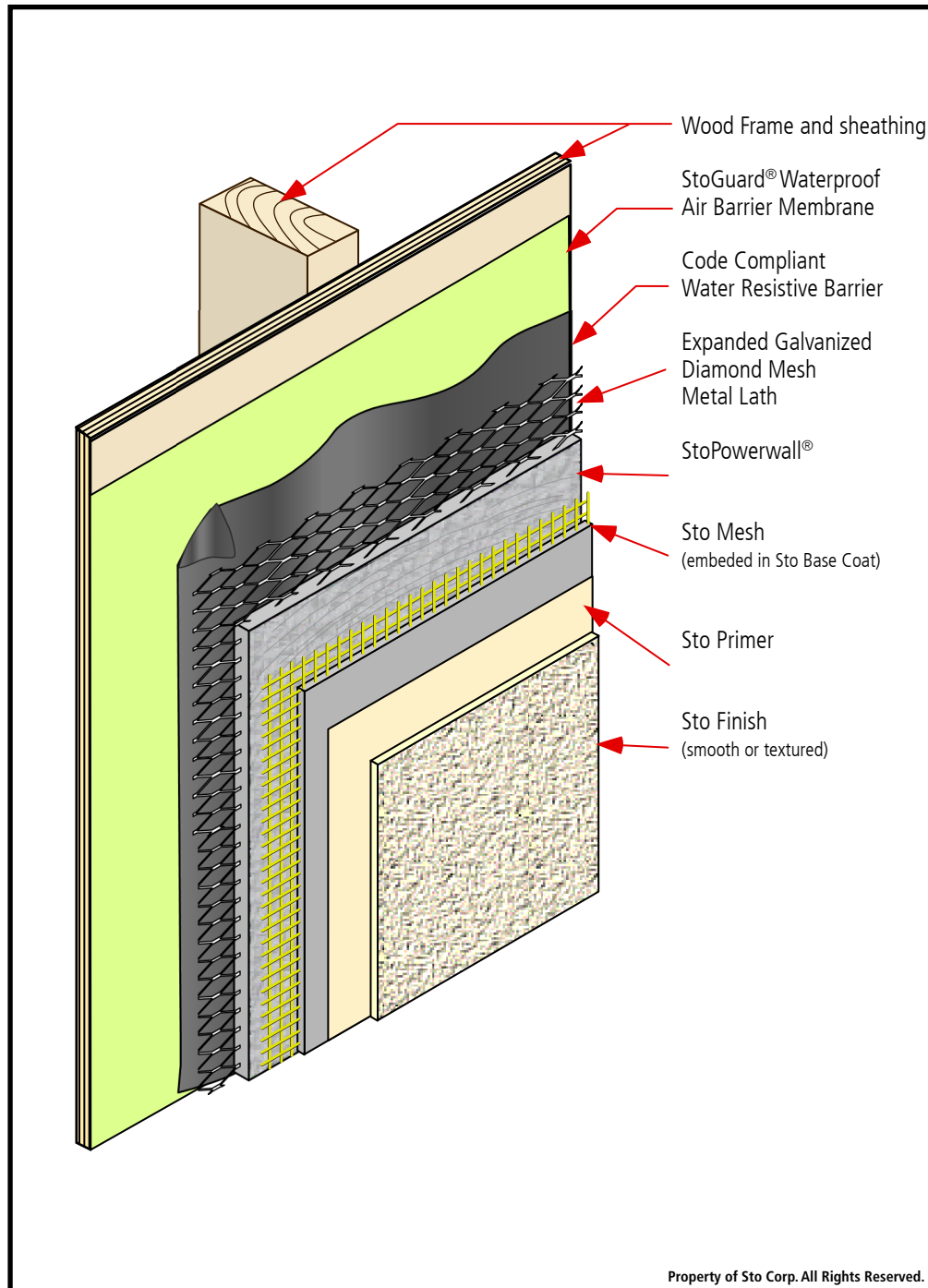

## Notes:

1. Detail shows the installation of StoPowerwall® with ArmorGuard over a wood frame wall.

## Sto Materials:

1. StoGuard® Waterproof Air Barrier Membrane options:

- a. Sto®EmeraldCoat® (high perm)
- b. StoGuard®VaporSeal™ (vapor impermeable)

2. StoPowerwall®

3. Sto Mesh

4. Sto Base coat

5. Sto Primer

6. Sto Finish (smooth or textured)

## Accessory Materials:

(including means for fastening)

1. Galvanized expanded diamond mesh metal lath
2. Casing bead
3. Other accessories as may be required (e.g. weep screeds, etc.)

IMPORTANT: Components not identified as Sto are furnished by other manufacturers and are not necessarily installed by trades who install the Sto products. Refer to project specific contract documents.

[www.stocorp.com](http://www.stocorp.com)

## ATTENTION

Sto products are intended for use by qualified professional contractors, not consumers, as a component of a larger construction assembly as specified by a qualified design professional, general contractor or builder. They should be installed in accordance with those specifications and Sto's instructions. Sto Corp. disclaims all, and assumes no, liability for on-site inspections, for its products applied improperly, or by unqualified persons or entities, or as part of an improperly designed or constructed building, for the nonperformance of adjacent building components or assemblies, or for other construction activities beyond Sto's control. Improper use of Sto products or use as part of an improperly designed or constructed larger assembly or building may result in serious damage to Sto products, and to the structure of the building or its components.

**STO CORP. DISCLAIMS ALL WARRANTIES EXPRESSED OR IMPLIED EXCEPT FOR EXPLICIT LIMITED WRITTEN WARRANTIES ISSUED TO AND ACCEPTED BY BUILDING OWNERS IN ACCORDANCE WITH STO'S WARRANTY PROGRAMS WHICH ARE SUBJECT TO CHANGE FROM TIME TO TIME.** For the fullest, most current information on proper application, clean-up, mixing and other specifications and warranties, cautions and disclaimers, please refer to the Sto Corp. website, [www.stocorp.com](http://www.stocorp.com).



# StoPowerwall® DrainScreen™ System Components over CMU

**Detail No.: 5.07 DS**

**Date: October 2014**

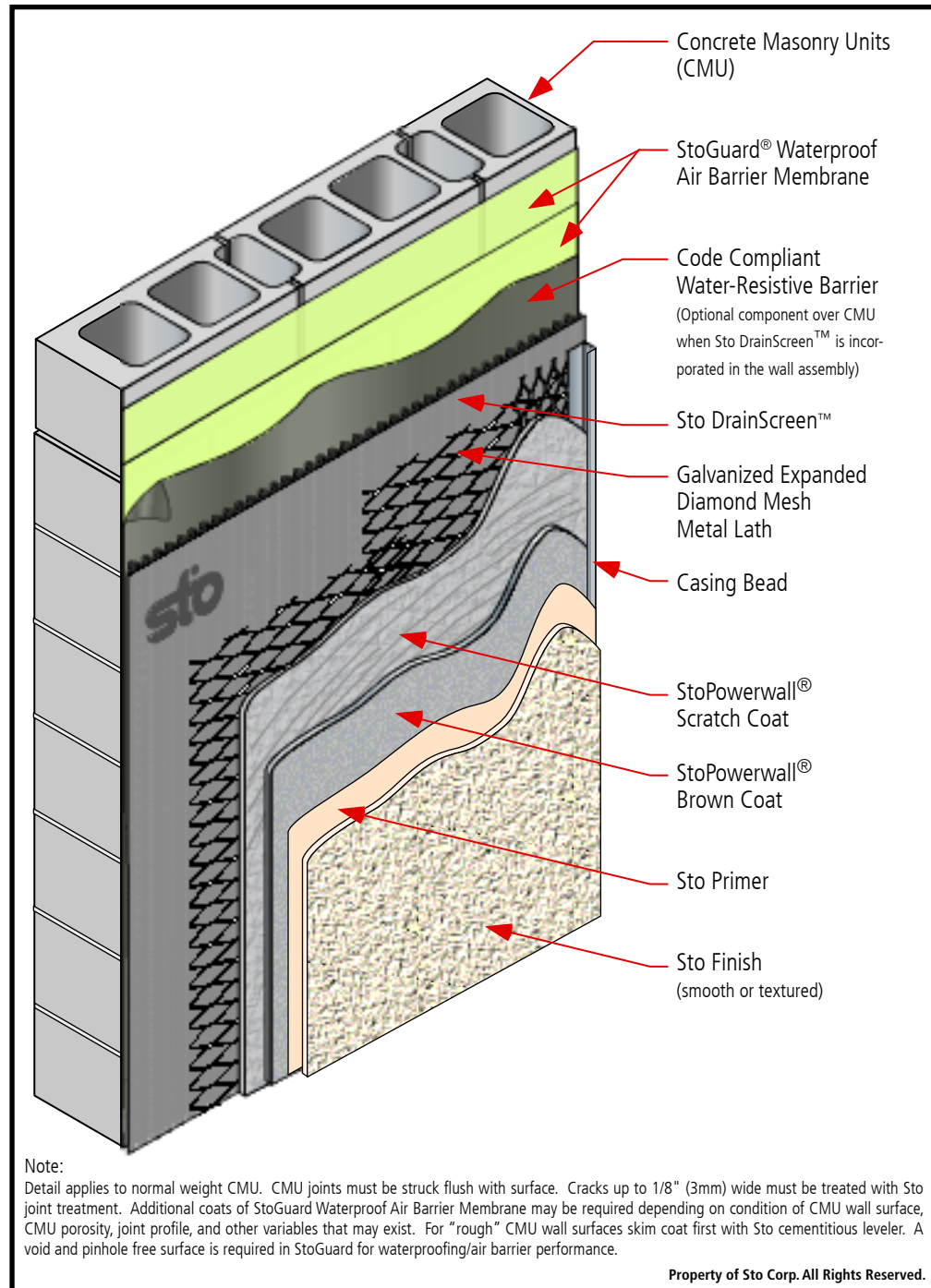

## **Notes:**

1. Detail shows the components of StoPowerwall® DrainScreen™ over CMU

## **Sto System Components:**

1. StoGuard® Waterproof Air Barrier Membrane options:
  - a. Sto EmeraldCoat®  
2 coat minimum  
(high perm)
  - b. StoGuard® VaporSeal™  
1x 32 mil dry coat minimum  
(vapor impermeable)
2. Sto DrainScreen™
3. StoPowerwall® scratch coat
4. StoPowerwall® brown coat
5. Sto Primer
6. Sto Finish  
(smooth or textured)

## **Accessory Materials:**

(including means for fastening)

1. Galvanized Expanded Diamond Mesh Metal Lath
2. Casing bead
3. Other accessories as may be required. (e.g. weep screeds)

**IMPORTANT:** Components not identified as Sto are furnished by other manufacturers and are not necessarily installed by trades who install the Sto products. Refer to project specific contract documents.

## **ATTENTION**

Sto products are intended for use by qualified professional contractors, not consumers, as a component of a larger construction assembly as specified by a qualified design professional, general contractor or builder. They should be installed in accordance with those specifications and Sto's instructions. Sto Corp. disclaims all, and assumes no, liability for on-site inspections, for its products applied improperly, or by unqualified persons or entities, or as part of an improperly designed or constructed building, for the nonperformance of adjacent building components or assemblies, or for other construction activities beyond Sto's control. Improper use of Sto products or use as part of an improperly designed or constructed larger assembly or building may result in serious damage to Sto products, and to the structure of the building or its components.

**STO CORP. DISCLAIMS ALL WARRANTIES EXPRESSED OR IMPLIED EXCEPT FOR EXPLICIT LIMITED WRITTEN WARRANTIES ISSUED TO AND ACCEPTED BY BUILDING OWNERS IN ACCORDANCE WITH STO'S WARRANTY PROGRAMS WHICH ARE SUBJECT TO CHANGE FROM TIME TO TIME.** For the fullest, most current information on proper application, clean-up, mixing and other specifications and warranties, cautions and disclaimers, please refer to the Sto Corp. website, [www.stocorp.com](http://www.stocorp.com).

[www.stocorp.com](http://www.stocorp.com)

# StoPowerwall® DrainScreen™ Joint, Rough Opening, and Transition Detail Treatments

Detail No.: 5.09 DS

Date: October 2014

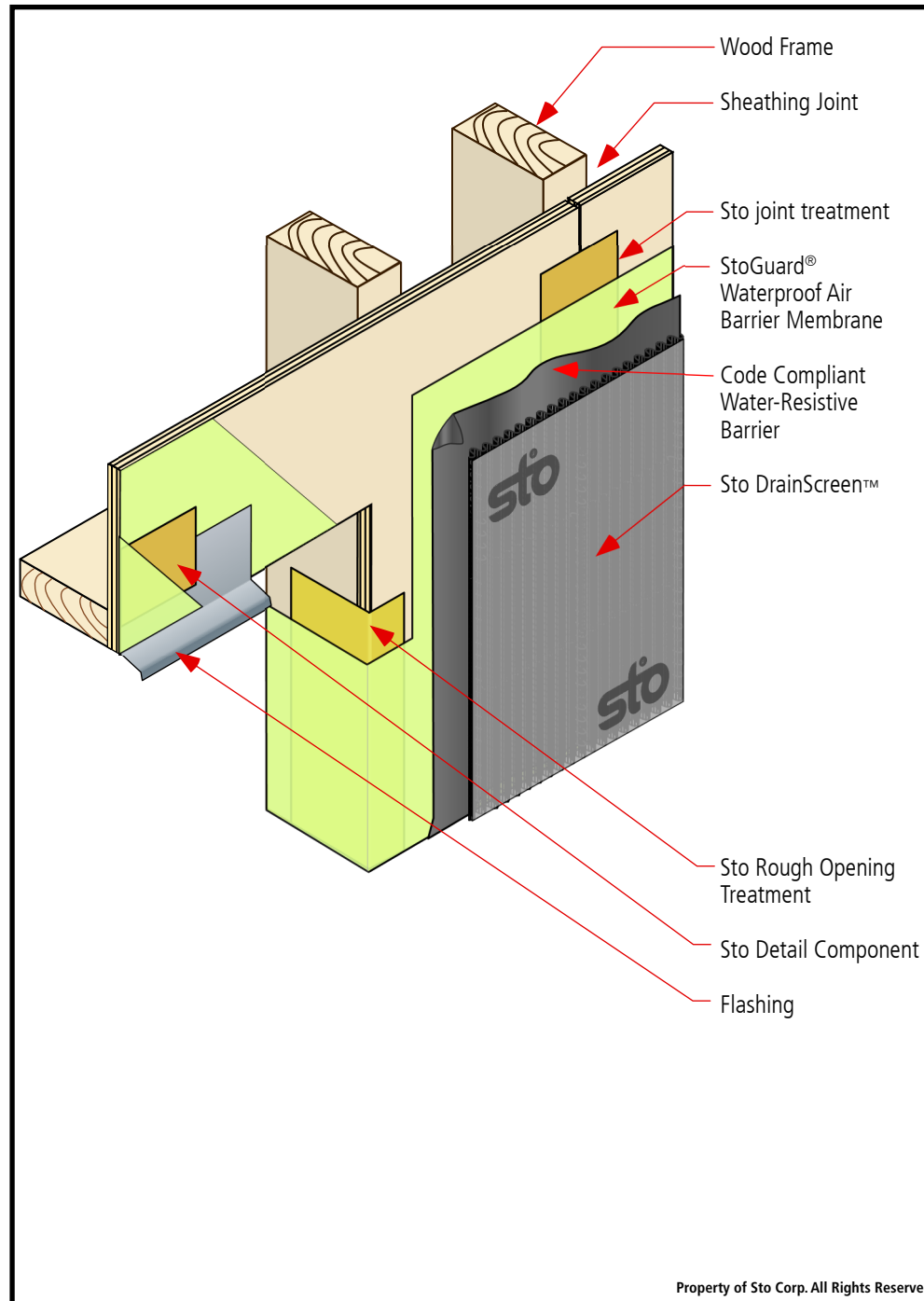

## Notes:

- Joint treatment options:
  - Sto Gold Fill with StoGuard® Mesh
  - StoGuard® Fabric embedded in StoGuard® Waterproof Air Barrier Membrane
  - StoGuard® RapidFill™
  - StoGuard® RapidSeal™ with StoGuard® Mesh
- Rough Opening treatment options:
  - Sto Gold Fill with StoGuard® Mesh
  - StoGuard® Fabric embedded in StoGuard® Waterproof Air Barrier Membrane
  - StoGuard® RapidSeal™ with StoGuard® Mesh
- Sto Detail Component options:
  - Sto Gold Fill with StoGuard® Mesh
  - StoGuard® Fabric embedded in StoGuard® Waterproof Air Barrier Membrane
  - StoGuard® RapidSeal™
  - StoGuard® RapidFill™
- StoGuard® Waterproof Air Barrier Membrane options:
  - Sto EmeraldCoat® (high perm)
  - StoGuard® VaporSeal™ (vapor impermeable)
- Refer to product bulletins for application information on joint treatments.

IMPORTANT: Components not identified as Sto are furnished by other manufacturers and are not necessarily installed by trades who install the Sto products. Refer to project specific contract documents.

## ATTENTION

Sto products are intended for use by qualified professional contractors, not consumers, as a component of a larger construction assembly as specified by a qualified design professional, general contractor or builder. They should be installed in accordance with those specifications and Sto's instructions. Sto Corp. disclaims all, and assumes no, liability for on-site inspections, for its products applied improperly, or by unqualified persons or entities, or as part of an improperly designed or constructed building, for the nonperformance of adjacent building components or assemblies, or for other construction activities beyond Sto's control. Improper use of Sto products or use as part of an improperly designed or constructed larger assembly or building may result in serious damage to Sto products, and to the structure of the building or its components.

STO CORP. DISCLAIMS ALL WARRANTIES EXPRESSED OR IMPLIED EXCEPT FOR EXPLICIT LIMITED WRITTEN WARRANTIES ISSUED TO AND ACCEPTED BY BUILDING OWNERS IN ACCORDANCE WITH STO'S WARRANTY PROGRAMS WHICH ARE SUBJECT TO CHANGE FROM TIME TO TIME. For the fullest, most current information on proper application, clean-up, mixing and other specifications and warranties, cautions and disclaimers, please refer to the Sto Corp. website, [www.stocorp.com](http://www.stocorp.com).

[www.stocorp.com](http://www.stocorp.com)

# StoPowerwall® DrainScreen™ Termination at Grade

Detail No.: 5.10 DS

Date: October 2014

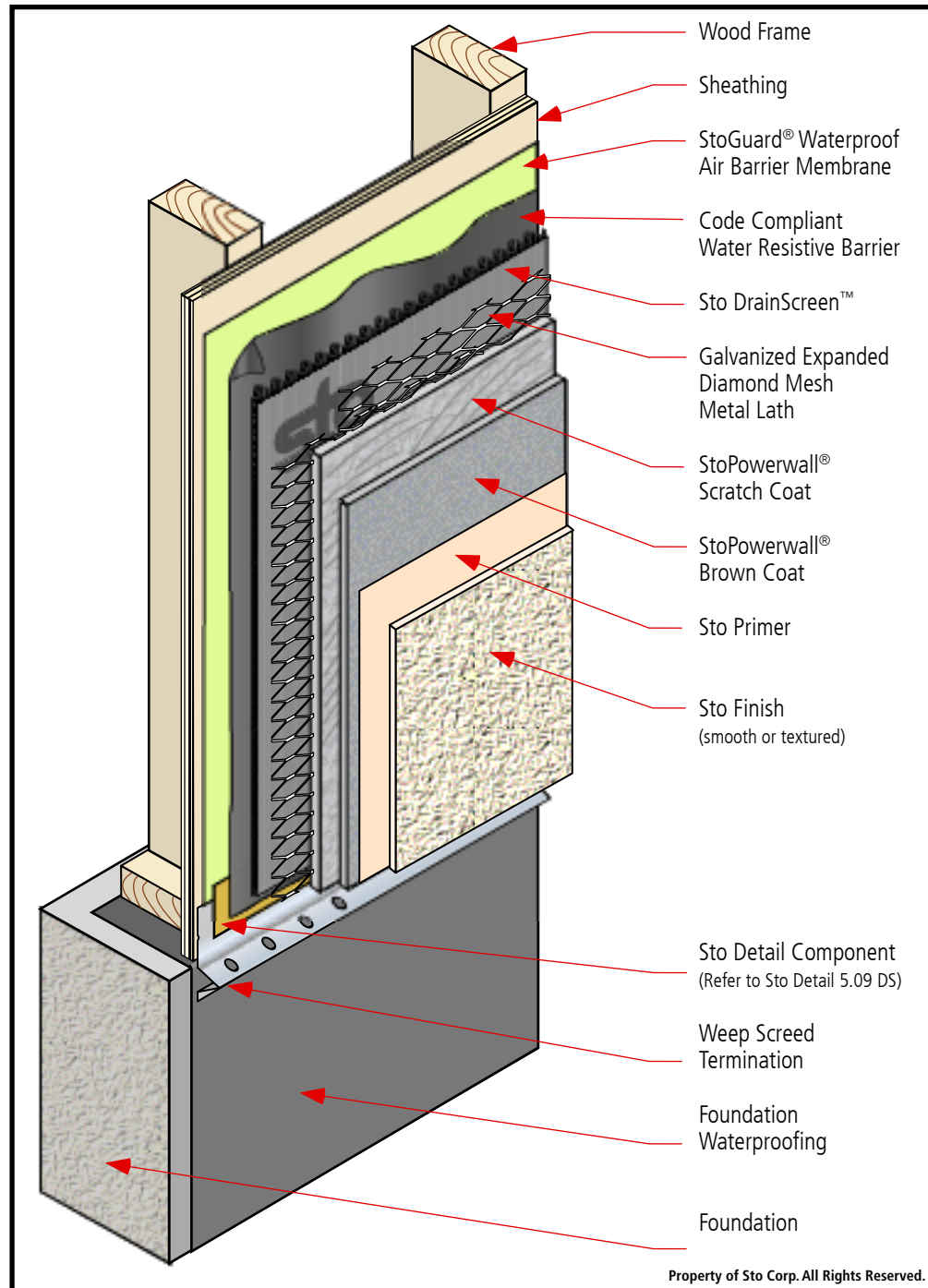

## Notes:

1. Install stucco weep screed to terminate a minimum of 1" below bottom of wood plate and a minimum of 8" above finished grade or as required by code.
2. Lap StoGuard® waterproof air barrier membrane, code compliant water resistive barrier and Sto DrainScreen™ onto weep screed to direct water to the exterior.
3. Provide waterproofing at the foundation to protect the support structure from rising damp.

## Options:

StoGuard® Waterproof Air Barrier Membrane options:

- a. Sto EmeraldCoat® (high perm)
- b. StoGuard® VaporSeal™ (vapor impermeable)

IMPORTANT: Components not identified as Sto are furnished by other manufacturers and are not necessarily installed by trades who install the Sto products. Refer to project specific contract documents.

## ATTENTION

Sto products are intended for use by qualified professional contractors, not consumers, as a component of a larger construction assembly as specified by a qualified design professional, general contractor or builder. They should be installed in accordance with those specifications and Sto's instructions. Sto Corp. disclaims all, and assumes no, liability for on-site inspections, for its products applied improperly, or by unqualified persons or entities, or as part of an improperly designed or constructed building, for the nonperformance of adjacent building components or assemblies, or for other construction activities beyond Sto's control. Improper use of Sto products or use as part of an improperly designed or constructed larger assembly or building may result in serious damage to Sto products, and to the structure of the building or its components.

STO CORP. DISCLAIMS ALL WARRANTIES EXPRESSED OR IMPLIED EXCEPT FOR EXPLICIT LIMITED WRITTEN WARRANTIES ISSUED TO AND ACCEPTED BY BUILDING OWNERS IN ACCORDANCE WITH STO'S WARRANTY PROGRAMS WHICH ARE SUBJECT TO CHANGE FROM TIME TO TIME. For the fullest, most current information on proper application, clean-up, mixing and other specifications and warranties, cautions and disclaimers, please refer to the Sto Corp. website, [www.stocorp.com](http://www.stocorp.com).

[www.stocorp.com](http://www.stocorp.com)

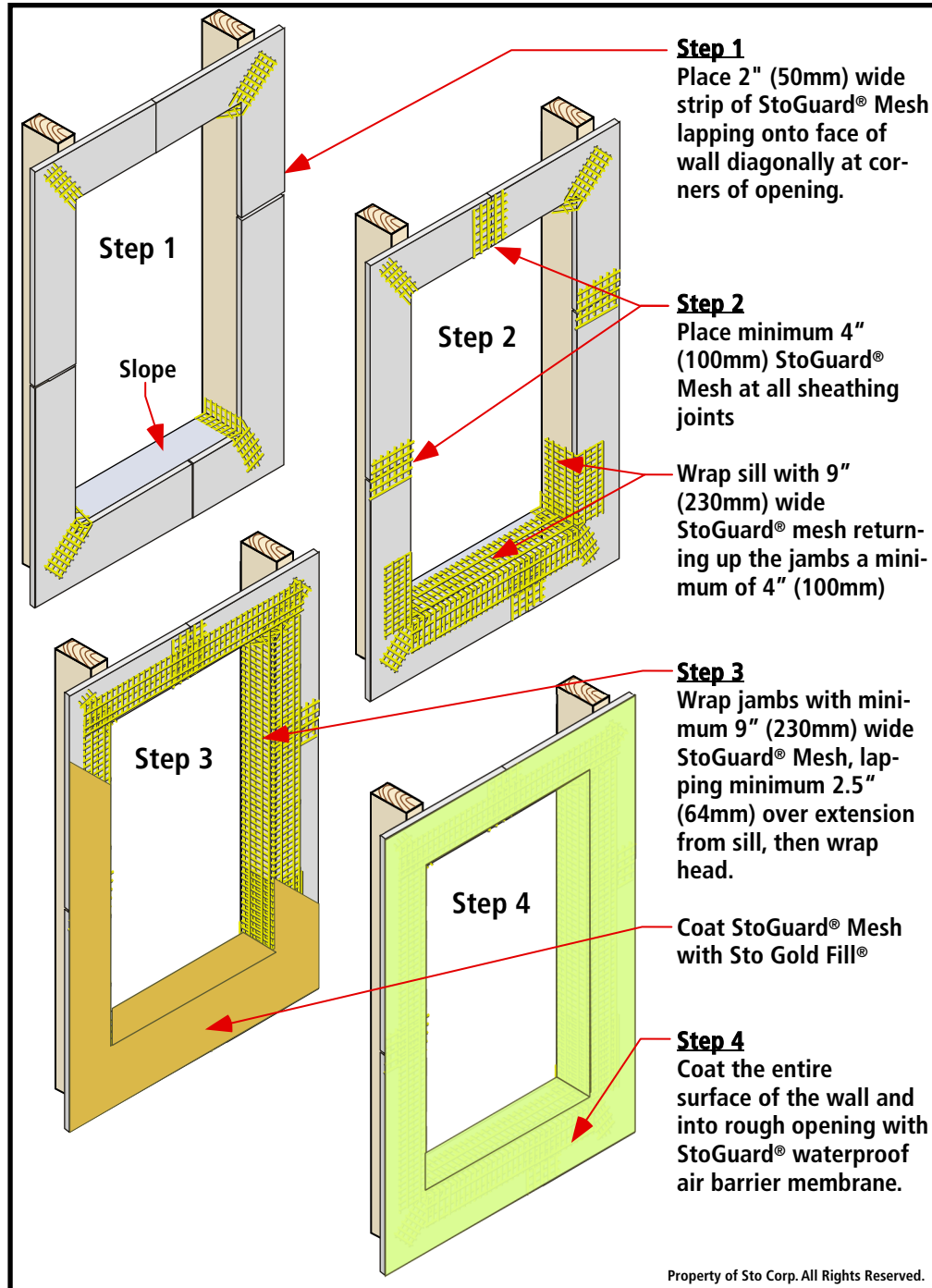

**StoPowerwall® DrainScreen™****Rough Opening Protection with Sto Gold Fill® and StoGuard® Mesh****Detail No.: 5.20 DS****Date: October 2014****Notes:**

1. StoGuard waterproof air barrier membrane options:
  - a. Sto EmeraldCoat® (high perm)
  - b. StoGuard® VaporSeal™ (vapor impermeable)
2. Prepare opening prior to the installation of the window or mechanical equipment. Provide sill wedge or other means for positive slope to exterior of sill.
3. Incorporate flashing as illustrated in other details where flashing is shown.
4. The complete installation of window or mechanical equipment must include an air seal between the object and the StoGuard® protection, inbound of the outer perimeter weather seal.
5. Refer to Sto specifications and product bulletins for detailed information on substrates and Sto material options. Additional water-resistive barrier and Sto DrainScreen™ not shown.

IMPORTANT: Components not identified as Sto are furnished by other manufacturers and are not necessarily installed by trades who install the Sto products. Refer to project specific contract documents.

**ATTENTION**

Sto products are intended for use by qualified professional contractors, not consumers, as a component of a larger construction assembly as specified by a qualified design professional, general contractor or builder. They should be installed in accordance with those specifications and Sto's instructions. Sto Corp. disclaims all, and assumes no, liability for on-site inspections, for its products applied improperly, or by unqualified persons or entities, or as part of an improperly designed or constructed building, for the nonperformance of adjacent building components or assemblies, or for other construction activities beyond Sto's control. Improper use of Sto products or use as part of an improperly designed or constructed larger assembly or building may result in serious damage to Sto products, and to the structure of the building or its components.

STO CORP. DISCLAIMS ALL WARRANTIES EXPRESSED OR IMPLIED EXCEPT FOR EXPLICIT LIMITED WRITTEN WARRANTIES ISSUED TO AND ACCEPTED BY BUILDING OWNERS IN ACCORDANCE WITH STO'S WARRANTY PROGRAMS WHICH ARE SUBJECT TO CHANGE FROM TIME TO TIME. For the fullest, most current information on proper application, clean-up, mixing and other specifications and warranties, cautions and disclaimers, please refer to the Sto Corp. website, [www.stocorp.com](http://www.stocorp.com).

[www.stocorp.com](http://www.stocorp.com)

# StoPowerwall® DrainScreen™ Rough Opening Preparation

**Detail No.: 5.21a DS**

**Date: October 2014**

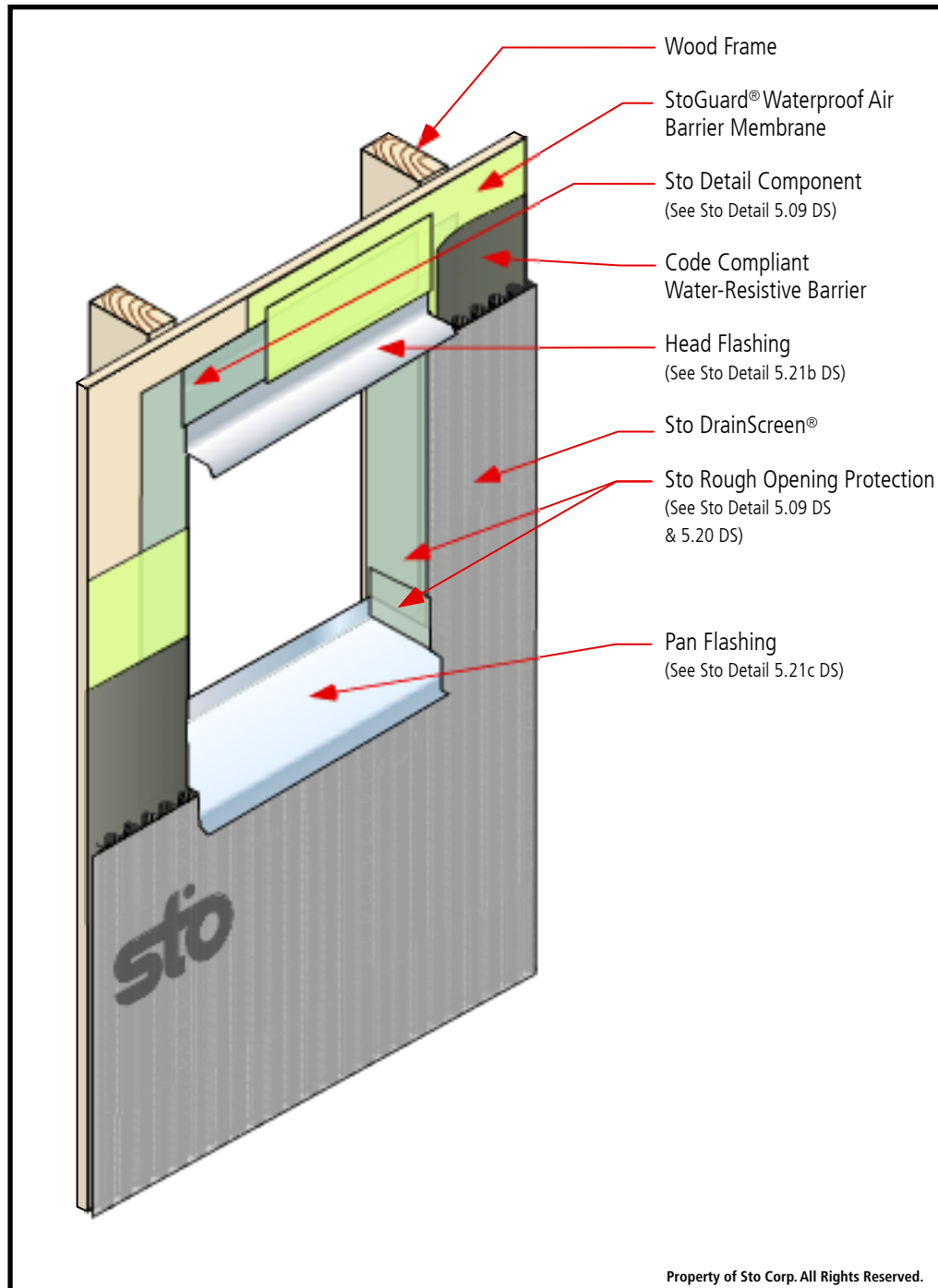

## Notes:

1. Prepare opening prior to the installation of the window or mechanical equipment. Coordinate installation with other associated trades.
2. Wrap the rough opening with Sto rough opening protection. Choose from Sto Details:
  - 5.20 M DS
  - 5.20 F DS
  - 5.20 T DS
  - 5.20 R DS
3. Coat the wall surface with StoGuard® Waterproof Air Barrier Membrane
4. Incorporate head flashing as noted in Sto Detail 5.21b
5. For box windows incorporate pan flashing as noted in Sto Detail 5.21c DS
6. For nail-fin windows incorporate sill flashing under the window as noted in Sto Detail 5.21d DS

## Options:

StoGuard® Waterproof Air Barrier Membrane options:

- a. Sto EmeraldCoat®  
(high perm)
- b. StoGuard® VaporSeal™  
(vapor impermeable)

IMPORTANT: Components not identified as Sto are furnished by other manufacturers and are not necessarily installed by trades who install the Sto products. Refer to project specific contract documents.

Property of Sto Corp. All Rights Reserved.

## **ATTENTION**

Sto products are intended for use by qualified professional contractors, not consumers, as a component of a larger construction assembly as specified by a qualified design professional, general contractor or builder. They should be installed in accordance with those specifications and Sto's instructions. Sto Corp. disclaims all, and assumes no, liability for on-site inspections, for its products applied improperly, or by unqualified persons or entities, or as part of an improperly designed or constructed building, for the nonperformance of adjacent building components or assemblies, or for other construction activities beyond Sto's control. Improper use of Sto products or use as part of an improperly designed or constructed larger assembly or building may result in serious damage to Sto products, and to the structure of the building or its components.

STO CORP. DISCLAIMS ALL WARRANTIES EXPRESSED OR IMPLIED EXCEPT FOR EXPLICIT LIMITED WRITTEN WARRANTIES ISSUED TO AND ACCEPTED BY BUILDING OWNERS IN ACCORDANCE WITH STO'S WARRANTY PROGRAMS WHICH ARE SUBJECT TO CHANGE FROM TIME TO TIME. For the fullest, most current information on proper application, clean-up, mixing and other specifications and warranties, cautions and disclaimers, please refer to the Sto Corp. website, [www.stocorp.com](http://www.stocorp.com).

[www.stocorp.com](http://www.stocorp.com)

# StoPowerwall® DrainScreen™ Window Head Flashing Preparation

Detail No.: 5.21b DS

Date: October 2014

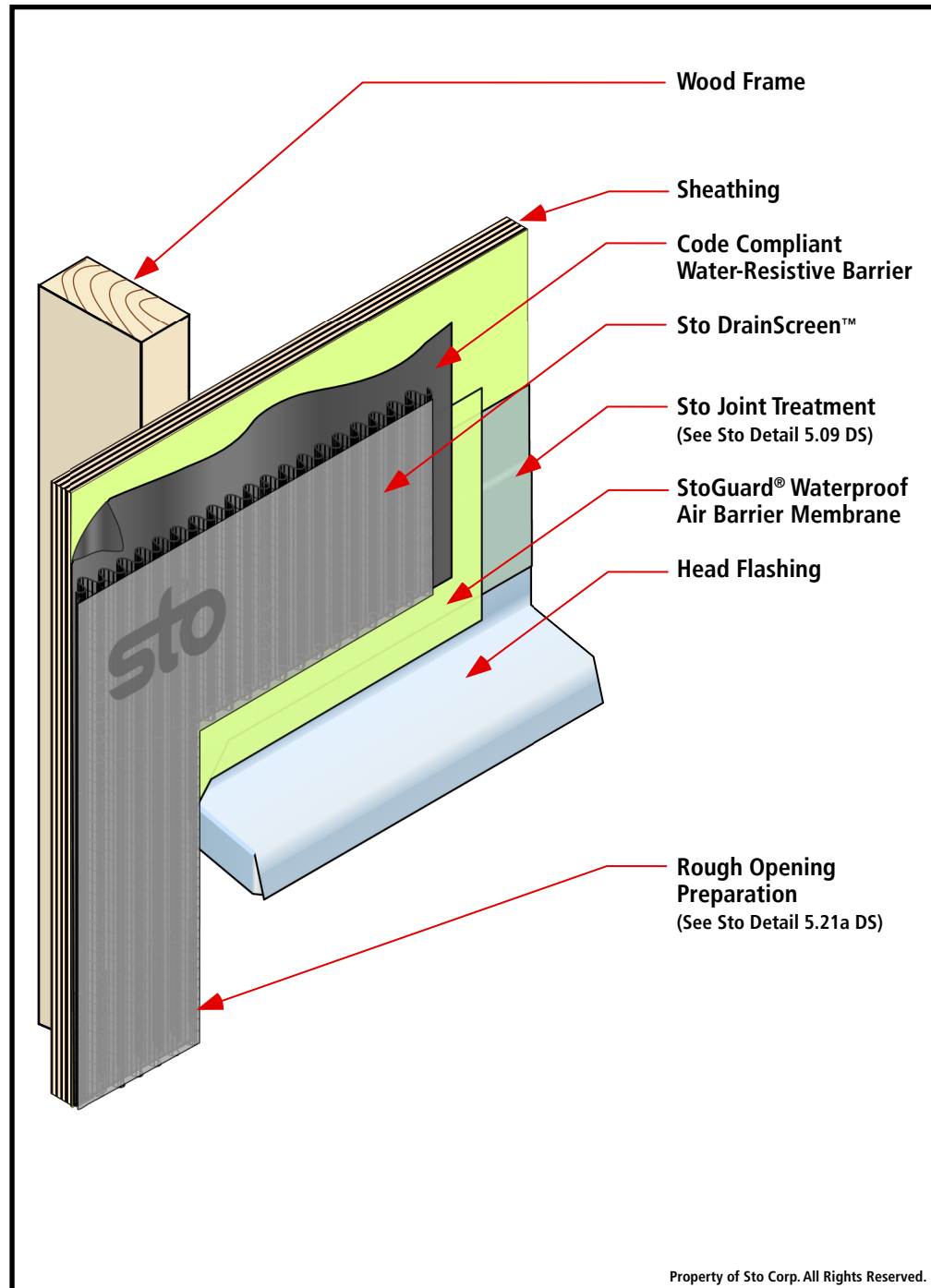

## Notes:

1. Prepare the rough opening  
(See Sto Detail 5.21a DS)
2. Provide head flashing as required by local codes and window manufacturer.
3. Coordinate installation of moisture barrier and flashing with window installer and other related trades.

## Options:

StoGuard® Waterproof Air Barrier Membrane options:

- a. Sto EmeraldCoat®  
(high perm)
- b. StoGuard® VaporSeal™  
(vapor impermeable).

IMPORTANT: Components not identified as Sto are furnished by other manufacturers and are not necessarily installed by trades who install the Sto products. Refer to project specific contract documents.

## ATTENTION

Sto products are intended for use by qualified professional contractors, not consumers, as a component of a larger construction assembly as specified by a qualified design professional, general contractor or builder. They should be installed in accordance with those specifications and Sto's instructions. Sto Corp. disclaims all, and assumes no, liability for on-site inspections, for its products applied improperly, or by unqualified persons or entities, or as part of an improperly designed or constructed building, for the nonperformance of adjacent building components or assemblies, or for other construction activities beyond Sto's control. Improper use of Sto products or use as part of an improperly designed or constructed larger assembly or building may result in serious damage to Sto products, and to the structure of the building or its components.

STO CORP. DISCLAIMS ALL WARRANTIES EXPRESSED OR IMPLIED EXCEPT FOR EXPLICIT LIMITED WRITTEN WARRANTIES ISSUED TO AND ACCEPTED BY BUILDING OWNERS IN ACCORDANCE WITH STO'S WARRANTY PROGRAMS WHICH ARE SUBJECT TO CHANGE FROM TIME TO TIME. For the fullest, most current information on proper application, clean-up, mixing and other specifications and warranties, cautions and disclaimers, please refer to the Sto Corp. website, [www.stocorp.com](http://www.stocorp.com).

[www.stocorp.com](http://www.stocorp.com)

# StoPowerwall<sup>®</sup> DrainScreen<sup>™</sup> Pan Flashing at Opening Sill

Detail No.: 5.21c DS

Date: October 2014

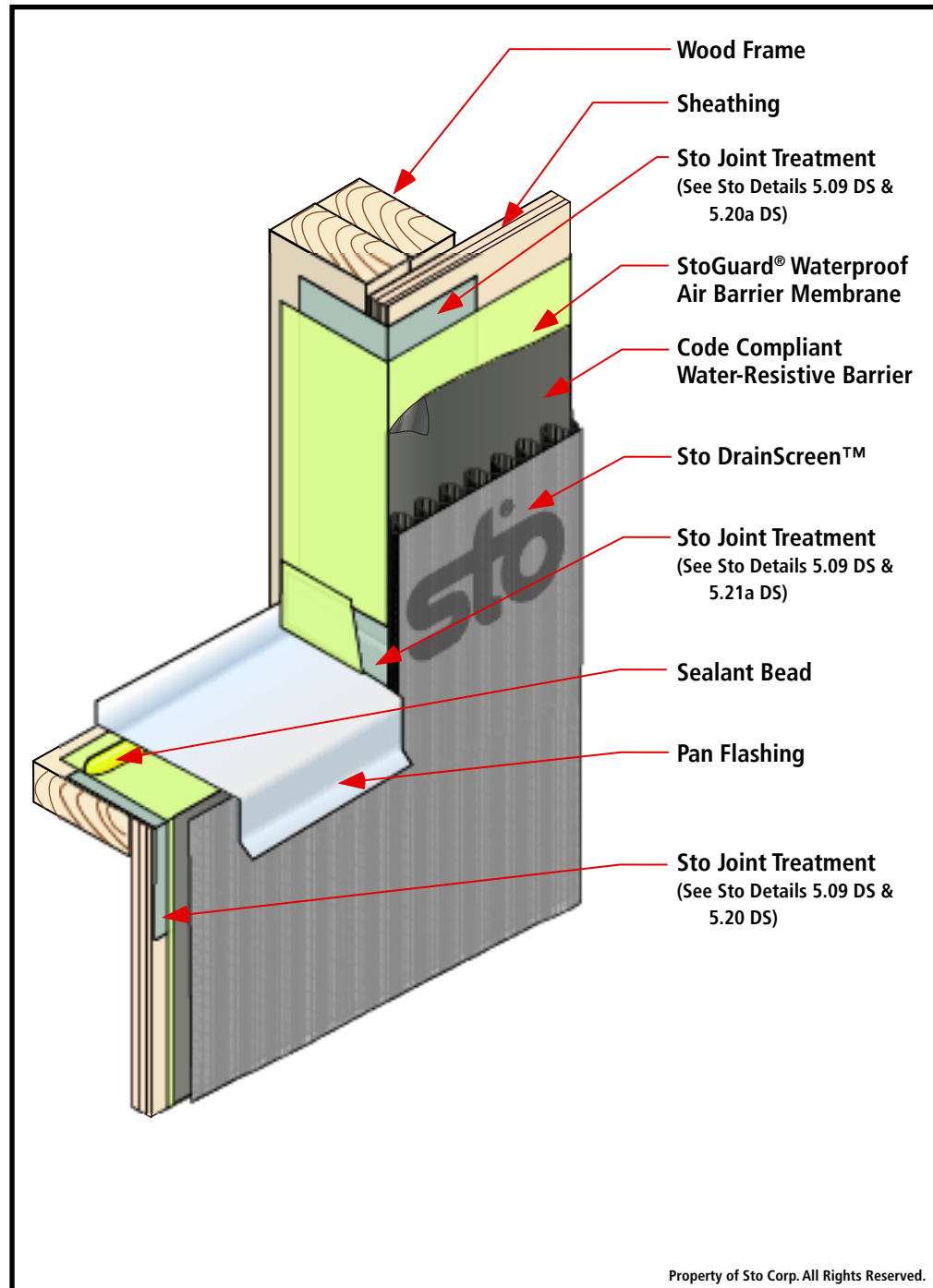

## Notes

1. Wrap opening as shown in Sto Detail 5.21a DS
2. Install one or more beads of neutral-cure, silicone sealant on the sill and jamb.
3. Install the sill pan flashing into the wet sealant and press it into place. Tool any excess sealant off at the top of the side dams and back edge of the pan flashing.
4. When installed the seal between the pan flashing and the rough opening protection must be air tight.
5. Install Sto Joint Treatment to the end dams so water draining down the jamb will be directed into the pan flashing and out of the wall assembly.

## Options:

StoGuard<sup>®</sup> Waterproof Air Barrier Membrane options:

- a. Sto EmeraldCoat<sup>®</sup>  
(high perm)
- b. Sto<sup>®</sup>VaporSeal<sup>™</sup>  
(vapor impermeable)

IMPORTANT: Components not identified as Sto are furnished by other manufacturers and are not necessarily installed by trades who install the Sto products. Refer to project specific contract documents.

## ATTENTION

Sto products are intended for use by qualified professional contractors, not consumers, as a component of a larger construction assembly as specified by a qualified design professional, general contractor or builder. They should be installed in accordance with those specifications and Sto's instructions. Sto Corp. disclaims all, and assumes no, liability for on-site inspections, for its products applied improperly, or by unqualified persons or entities, or as part of an improperly designed or constructed building, for the nonperformance of adjacent building components or assemblies, or for other construction activities beyond Sto's control. Improper use of Sto products or use as part of an improperly designed or constructed larger assembly or building may result in serious damage to Sto products, and to the structure of the building or its components.

STO CORP. DISCLAIMS ALL WARRANTIES EXPRESSED OR IMPLIED EXCEPT FOR EXPLICIT LIMITED WRITTEN WARRANTIES ISSUED TO AND ACCEPTED BY BUILDING OWNERS IN ACCORDANCE WITH STO'S WARRANTY PROGRAMS WHICH ARE SUBJECT TO CHANGE FROM TIME TO TIME. For the fullest, most current information on proper application, clean-up, mixing and other specifications and warranties, cautions and disclaimers, please refer to the Sto Corp. website, [www.stocorp.com](http://www.stocorp.com).

[www.stocorp.com](http://www.stocorp.com)

# StoPowerwall® DrainScreen™ Sill Flashing: Nail-fin Window

Detail No.: 5.21d DS

Date: October 2014

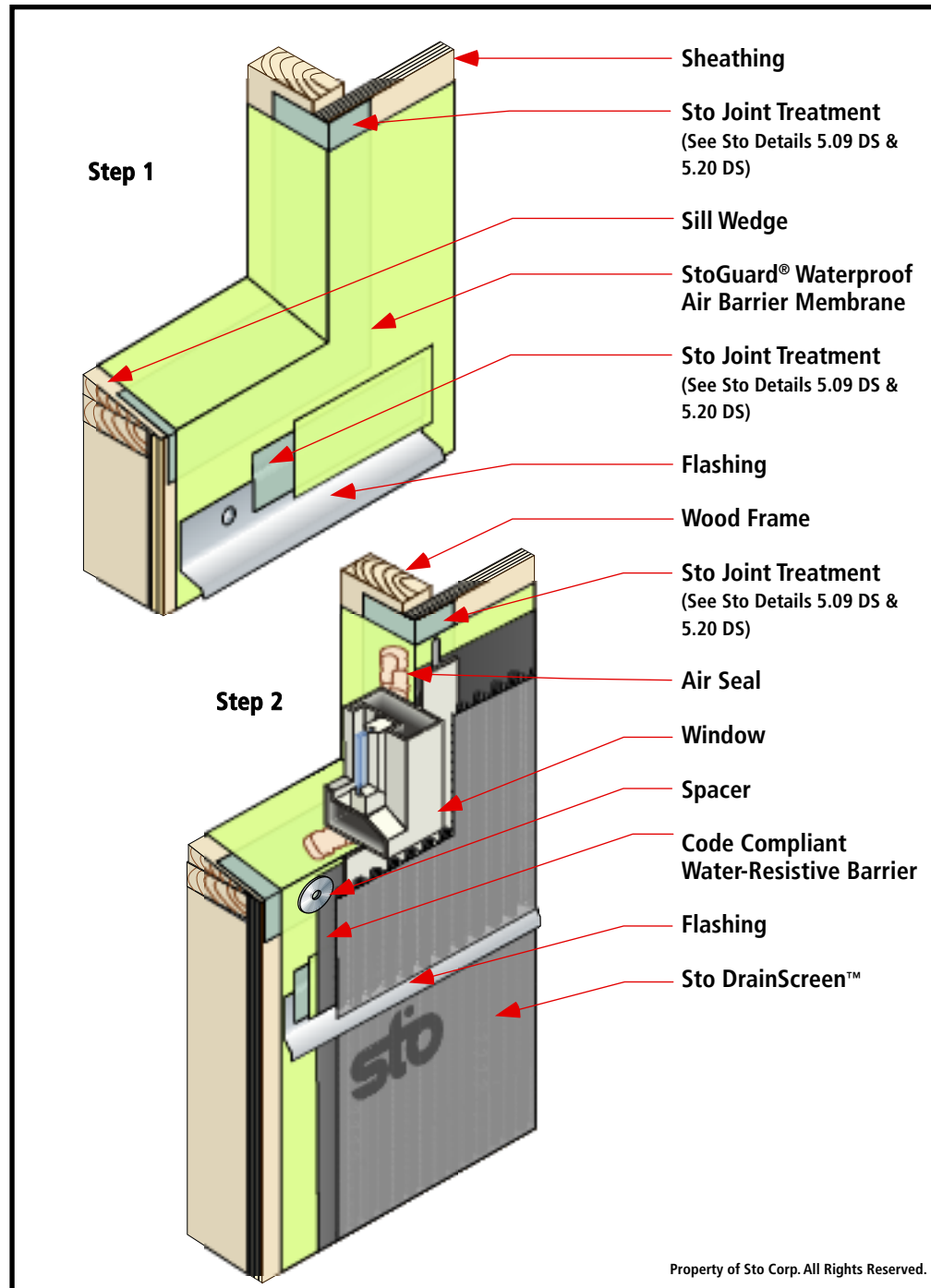
**Notes:**

1. Prepare rough opening.  
(See Sto Detail 5.20 DS)
2. Install flashing below the rough opening.
3. Prepare the flashing with Sto Joint Treatment.
4. Install the nail-fin window with an air seal around the interior perimeter of the window and with spacers at the sill to create a gap for water to drain between the sill flange and the StoGuard® Waterproof Air Barrier Membrane

**Options:**

StoGuard® Waterproof Air Barrier Membrane options:

- a. Sto EmeraldCoat®  
(high perm)
- b. StoGuard® VaporSeal™  
(vapor impermeable)

IMPORTANT: Components not identified as Sto are furnished by other manufacturers and are not necessarily installed by trades who install the Sto products. Refer to project specific contract documents.

**ATTENTION**

Sto products are intended for use by qualified professional contractors, not consumers, as a component of a larger construction assembly as specified by a qualified design professional, general contractor or builder. They should be installed in accordance with those specifications and Sto's instructions. Sto Corp. disclaims all, and assumes no, liability for on-site inspections, for its products applied improperly, or by unqualified persons or entities, or as part of an improperly designed or constructed building, for the nonperformance of adjacent building components or assemblies, or for other construction activities beyond Sto's control. Improper use of Sto products or use as part of an improperly designed or constructed larger assembly or building may result in serious damage to Sto products, and to the structure of the building or its components.

STO CORP. DISCLAIMS ALL WARRANTIES EXPRESSED OR IMPLIED EXCEPT FOR EXPLICIT LIMITED WRITTEN WARRANTIES ISSUED TO AND ACCEPTED BY BUILDING OWNERS IN ACCORDANCE WITH STO'S WARRANTY PROGRAMS WHICH ARE SUBJECT TO CHANGE FROM TIME TO TIME. For the fullest, most current information on proper application, clean-up, mixing and other specifications and warranties, cautions and disclaimers, please refer to the Sto Corp. website, [www.stocorp.com](http://www.stocorp.com).

[www.stocorp.com](http://www.stocorp.com)



# StoPowerwall® DrainScreen™ Brick Mold Window Sill / Jamb

Detail No.: 5.22 DS

Date: October 2014

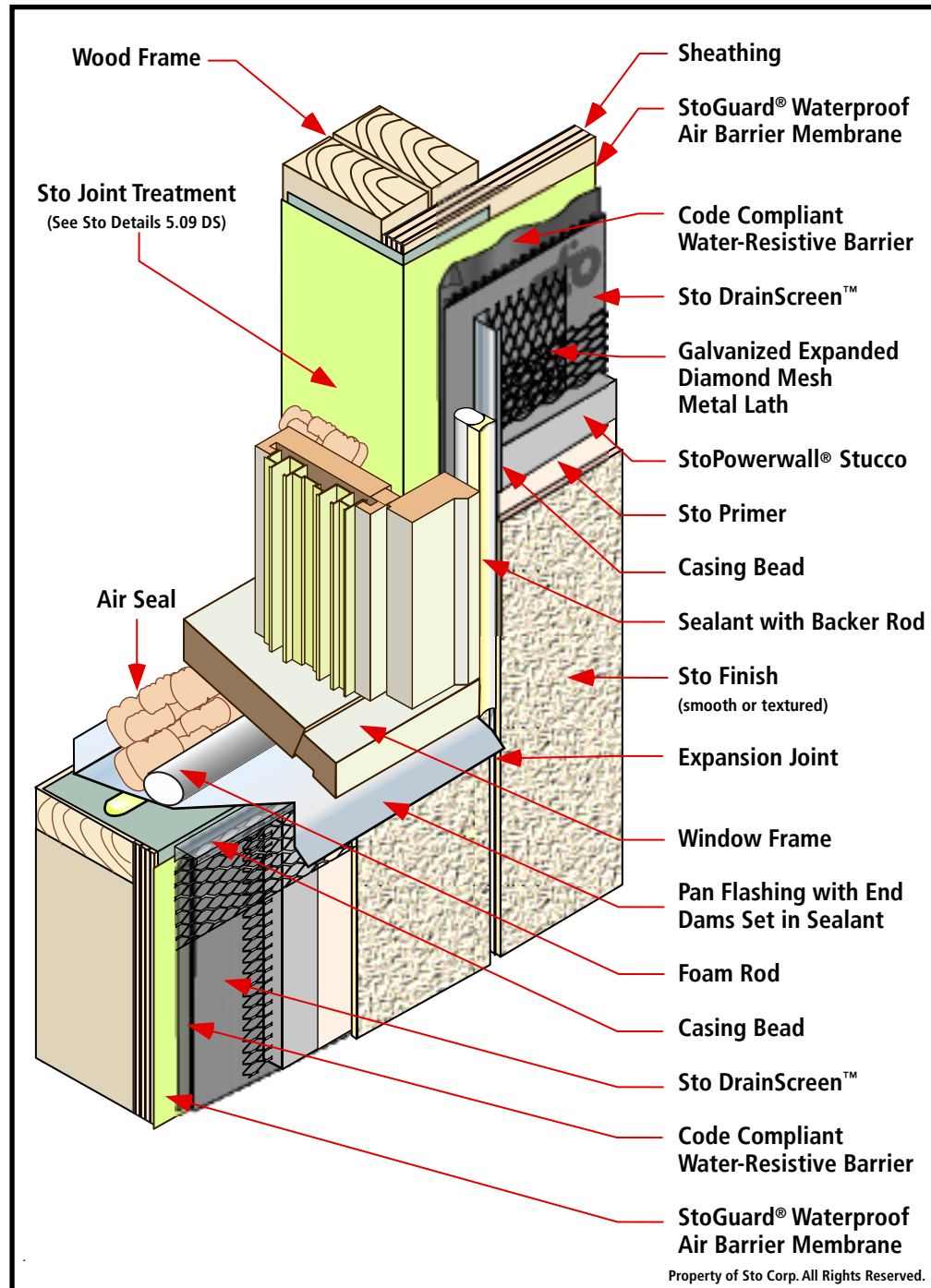

## Notes:

1. Protect the rough opening from water penetration by wrapping with Sto Joint Treatment.  
(See Sto Details 5.09 DS & 5.23a DS).  
  
Direct any water penetration to the exterior at the sill pan flashing.
2. Lap the Sto joint treatment into the sill pan.
3. Provide a continuous air barrier around the interior perimeter of the window to reduce leaking, condensation related to air movement, and sound and insect control.
4. Provide expansion joint at the corner of the window opening for stress relief.

## Options:

StoGuard® Waterproof Air Barrier Membrane options:

- a. Sto EmeraldCoat®  
(high perm)
- b. StoGuard® VaporSeal™  
(vapor impermeable)

IMPORTANT: Components not identified as Sto are furnished by other manufacturers and are not necessarily installed by trades who install the Sto products. Refer to project specific contract documents.

## ATTENTION

Sto products are intended for use by qualified professional contractors, not consumers, as a component of a larger construction assembly as specified by a qualified design professional, general contractor or builder. They should be installed in accordance with those specifications and Sto's instructions. Sto Corp. disclaims all, and assumes no, liability for on-site inspections, for its products applied improperly, or by unqualified persons or entities, or as part of an improperly designed or constructed building, for the nonperformance of adjacent building components or assemblies, or for other construction activities beyond Sto's control. Improper use of Sto products or use as part of an improperly designed or constructed larger assembly or building may result in serious damage to Sto products, and to the structure of the building or its components.

STO CORP. DISCLAIMS ALL WARRANTIES EXPRESSED OR IMPLIED EXCEPT FOR EXPLICIT LIMITED WRITTEN WARRANTIES ISSUED TO AND ACCEPTED BY BUILDING OWNERS IN ACCORDANCE WITH STO'S WARRANTY PROGRAMS WHICH ARE SUBJECT TO CHANGE FROM TIME TO TIME. For the fullest, most current information on proper application, clean-up, mixing and other specifications and warranties, cautions and disclaimers, please refer to the Sto Corp. website, [www.stocorp.com](http://www.stocorp.com).

[www.stocorp.com](http://www.stocorp.com)

# StoPowerwall® DrainScreen™ Brick Mold Window Head

Detail No.: 5.23 DS

Date: October 2014

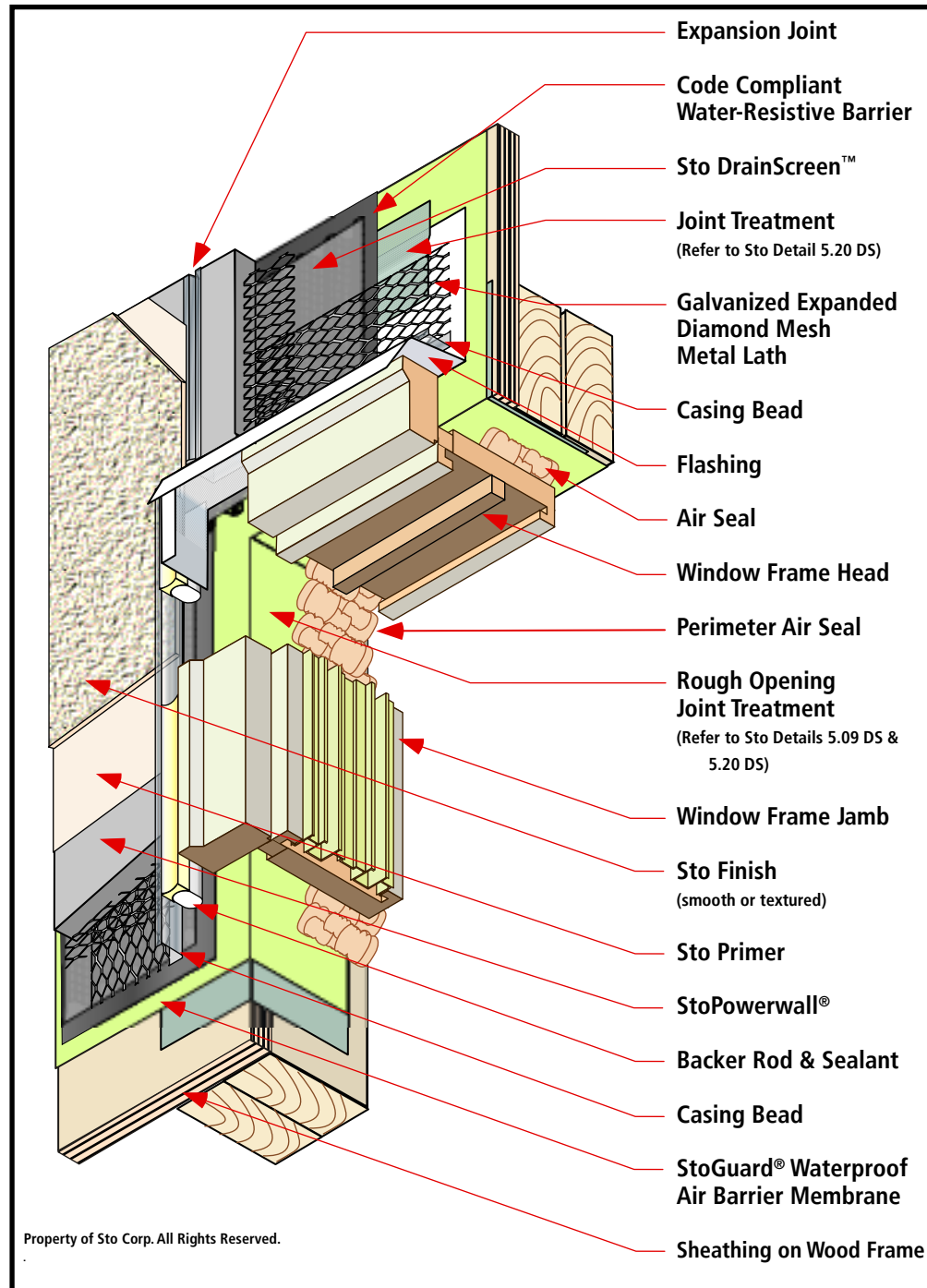

## Notes:

1. Protect the rough opening from water penetration by wrapping with StoGuard® (See Sto Details: 5.09 DS and 5.20 DS)
2. Provide head flashing over the window to direct water away from the window. Fold flashing over the window head-jamb interface or provide head flashing end dams, depending on window type and design.
3. Provide continuous air barrier around the interior perimeter of the window to reduce leaking, condensation related to air movement, sound and insect intrusion.
4. Install expansion joint at the corner of the opening to allow for the release of stresses in the stucco

## Options:

StoGuard® Waterproof Air Barrier Membrane options:

- a. Sto EmeraldCoat®  
(high perm)
- b. StoGuard® VaporSeal™  
(vapor impermeable)

IMPORTANT: Components not identified as Sto are furnished by other manufacturers and are not necessarily installed by trades who install the Sto products. Refer to project specific contract documents.

## ATTENTION

Sto products are intended for use by qualified professional contractors, not consumers, as a component of a larger construction assembly as specified by a qualified design professional, general contractor or builder. They should be installed in accordance with those specifications and Sto's instructions. Sto Corp. disclaims all, and assumes no, liability for on-site inspections, for its products applied improperly, or by unqualified persons or entities, or as part of an improperly designed or constructed building, for the nonperformance of adjacent building components or assemblies, or for other construction activities beyond Sto's control. Improper use of Sto products or use as part of an improperly designed or constructed larger assembly or building may result in serious damage to Sto products, and to the structure of the building or its components.

STO CORP. DISCLAIMS ALL WARRANTIES EXPRESSED OR IMPLIED EXCEPT FOR EXPLICIT LIMITED WRITTEN WARRANTIES ISSUED TO AND ACCEPTED BY BUILDING OWNERS IN ACCORDANCE WITH STO'S WARRANTY PROGRAMS WHICH ARE SUBJECT TO CHANGE FROM TIME TO TIME. For the fullest, most current information on proper application, clean-up, mixing and other specifications and warranties, cautions and disclaimers, please refer to the Sto Corp. website, [www.stocorp.com](http://www.stocorp.com).

[www.stocorp.com](http://www.stocorp.com)

# StoPowerwall® DrainScreen™ Termination at Soffit

Detail No.: 5.40 DS

Date: October 2014

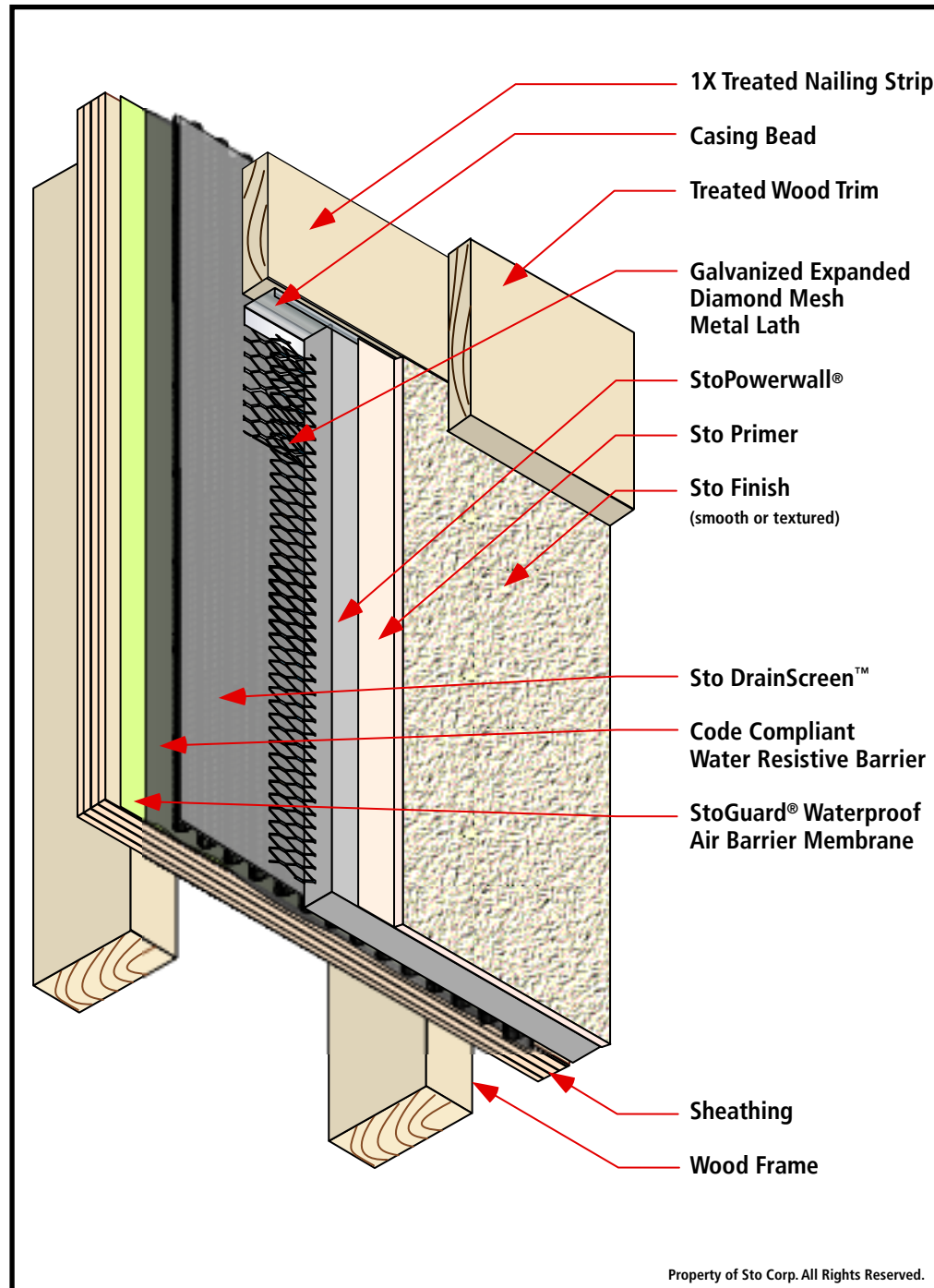

## Notes:

1. Install StoGuard® Waterproof Air Barrier Membrane on the sheathing as per plans and specifications.
2. StoGuard® air barrier is a component in the air barrier assembly for a building.

The design professional or builder must provide connections to other components in the system to make the entire envelope air tight. This detail assumes that the air barrier connection would be made prior to the installation of the 1x treated nailing strip.

## Options:

StoGuard® Waterproof Air Barrier Membrane options:

- a. Sto EmeraldCoat® (high perm)
- b. StoGuard® VaporSeal™ (vapor impermeable).

IMPORTANT: Components not identified as Sto are furnished by other manufacturers and are not necessarily installed by trades who install the Sto products. Refer to project specific contract documents.

## ATTENTION

Sto products are intended for use by qualified professional contractors, not consumers, as a component of a larger construction assembly as specified by a qualified design professional, general contractor or builder. They should be installed in accordance with those specifications and Sto's instructions. Sto Corp. disclaims all, and assumes no, liability for on-site inspections, for its products applied improperly, or by unqualified persons or entities, or as part of an improperly designed or constructed building, for the nonperformance of adjacent building components or assemblies, or for other construction activities beyond Sto's control. Improper use of Sto products or use as part of an improperly designed or constructed larger assembly or building may result in serious damage to Sto products, and to the structure of the building or its components.

STO CORP. DISCLAIMS ALL WARRANTIES EXPRESSED OR IMPLIED EXCEPT FOR EXPLICIT LIMITED WRITTEN WARRANTIES ISSUED TO AND ACCEPTED BY BUILDING OWNERS IN ACCORDANCE WITH STO'S WARRANTY PROGRAMS WHICH ARE SUBJECT TO CHANGE FROM TIME TO TIME. For the fullest, most current information on proper application, clean-up, mixing and other specifications and warranties, cautions and disclaimers, please refer to the Sto Corp. website, [www.stocorp.com](http://www.stocorp.com).

[www.stocorp.com](http://www.stocorp.com)

# StoPowerwall® DrainScreen™ Floor Expansion Joint

Detail No.: 5.50 DS

Date: October 2014

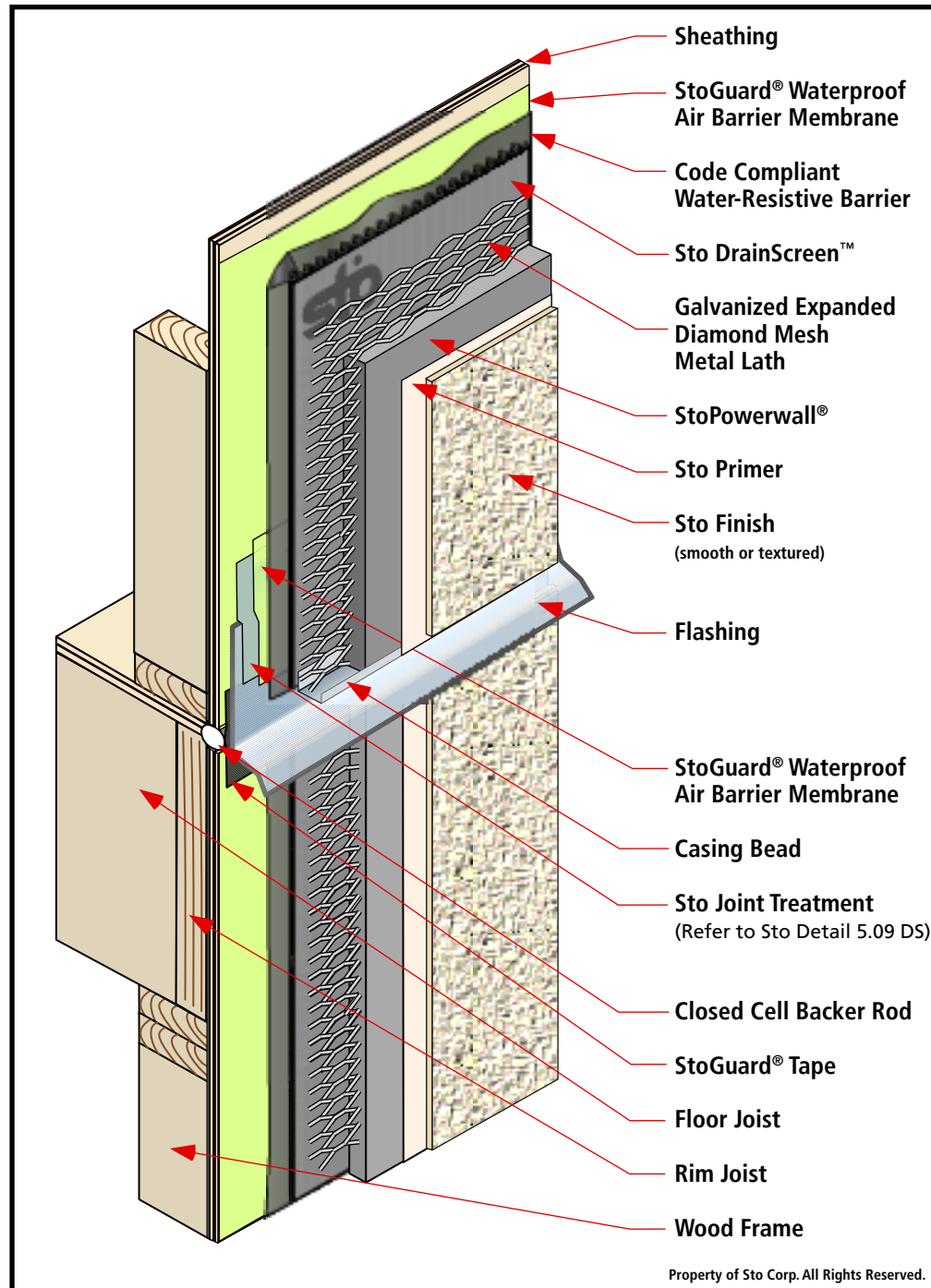

Property of Sto Corp. All Rights Reserved.

## Notes:

1. Install closed-cell backer rod into sheathing joint to support barrier membrane.
2. Install StoGuard® Tape so that it laps over StoGuard® below. Clamp the top edge of StoGuard® Tape with the flashing and shingle lap StoGuard® joint treatment over the flashing leg.

## Options:

StoGuard® Waterproof Air Barrier Membrane options:

- a. Sto EmeraldCoat® (high perm)
- b. StoGuard® VaporSeal™ (vapor impermeable).

IMPORTANT: Components not identified as Sto are furnished by other manufacturers and are not necessarily installed by trades who install the Sto products. Refer to project specific contract documents.

## ATTENTION

Sto products are intended for use by qualified professional contractors, not consumers, as a component of a larger construction assembly as specified by a qualified design professional, general contractor or builder. They should be installed in accordance with those specifications and Sto's instructions. Sto Corp. disclaims all, and assumes no, liability for on-site inspections, for its products applied improperly, or by unqualified persons or entities, or as part of an improperly designed or constructed building, for the nonperformance of adjacent building components or assemblies, or for other construction activities beyond Sto's control. Improper use of Sto products or use as part of an improperly designed or constructed larger assembly or building may result in serious damage to Sto products, and to the structure of the building or its components.

STO CORP. DISCLAIMS ALL WARRANTIES EXPRESSED OR IMPLIED EXCEPT FOR EXPLICIT LIMITED WRITTEN WARRANTIES ISSUED TO AND ACCEPTED BY BUILDING OWNERS IN ACCORDANCE WITH STO'S WARRANTY PROGRAMS WHICH ARE SUBJECT TO CHANGE FROM TIME TO TIME. For the fullest, most current information on proper application, clean-up, mixing and other specifications and warranties, cautions and disclaimers, please refer to the Sto Corp. website, [www.stocorp.com](http://www.stocorp.com).

[www.stocorp.com](http://www.stocorp.com)



# StoPowerwall® DrainScreen™ One-Piece Expansion Joint (ASTM C 1063 Control Joint)

Detail No.: 5.52 DS

Date: October 2014

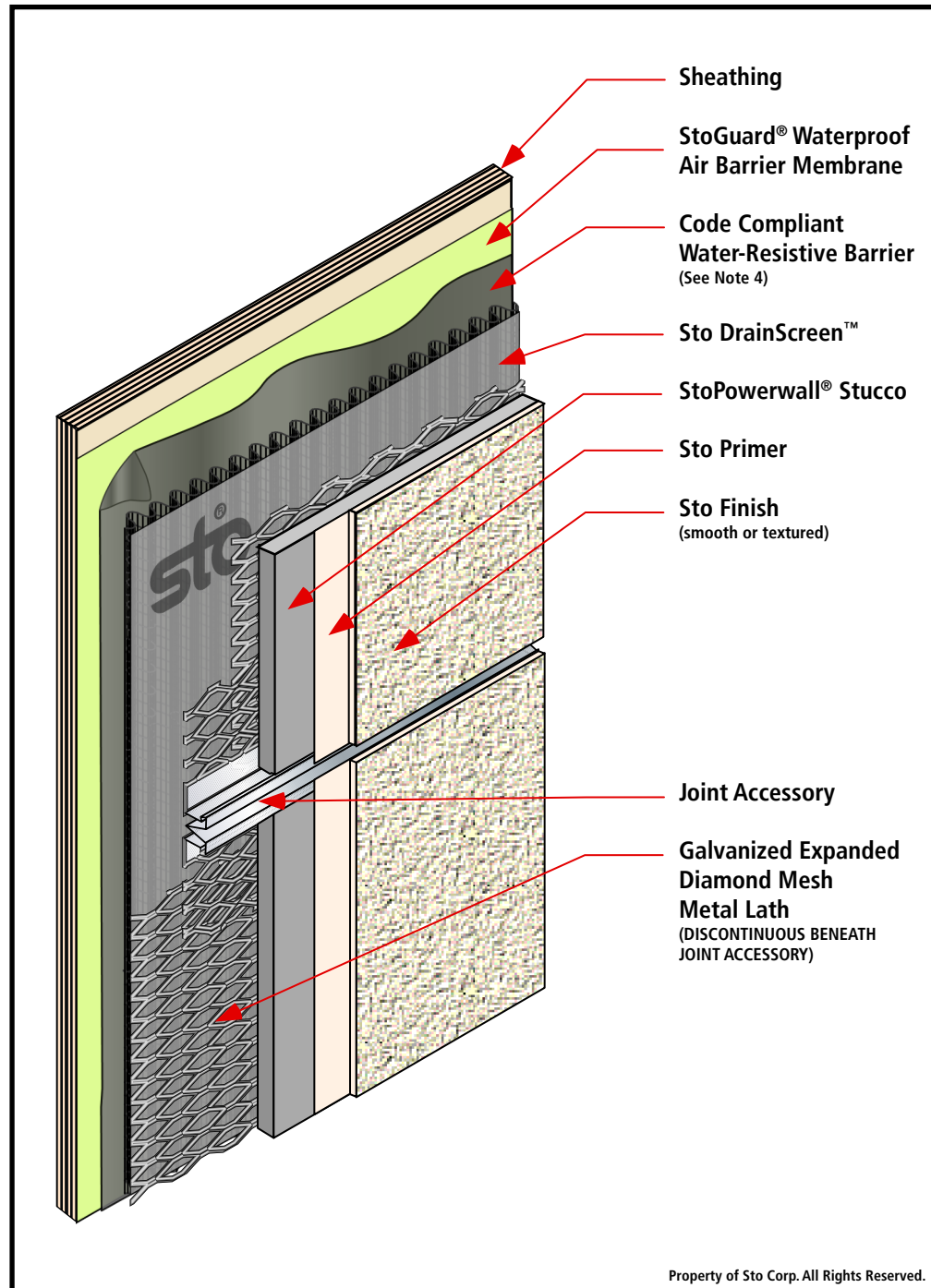
**Notes:**

1. Provide one-piece expansion joints at minimum 144 ft<sup>2</sup> (13.4 m<sup>2</sup>) intervals and typically above and below window, door, and similar openings in the wall construction.
2. Do not exceed length to width ratio of 2.5:1 in joint layout and do not exceed 18 ft (5.5 m) in any direction without a joint.
3. Lap metal reinforcement (lath) over joint accessory flanges and wire tie. Alternatively, install metal reinforcement, snip (cut) at line of accessory, and wire tie joint accessory over metal reinforcement.

**METAL REINFORCEMENT MUST BE DISCONTINUOUS BENEATH THE JOINT ACCESSORY**

IMPORTANT: Components not identified as Sto are furnished by other manufacturers and are not necessarily installed by trades who install the Sto products. Refer to project specific contract documents.

Property of Sto Corp. All Rights Reserved.

**ATTENTION**

Sto products are intended for use by qualified professional contractors, not consumers, as a component of a larger construction assembly as specified by a qualified design professional, general contractor or builder. They should be installed in accordance with those specifications and Sto's instructions. Sto Corp. disclaims all, and assumes no, liability for on-site inspections, for its products applied improperly, or by unqualified persons or entities, or as part of an improperly designed or constructed building, for the nonperformance of adjacent building components or assemblies, or for other construction activities beyond Sto's control. Improper use of Sto products or use as part of an improperly designed or constructed larger assembly or building may result in serious damage to Sto products, and to the structure of the building or its components.

STO CORP. DISCLAIMS ALL WARRANTIES EXPRESSED OR IMPLIED EXCEPT FOR EXPLICIT LIMITED WRITTEN WARRANTIES ISSUED TO AND ACCEPTED BY BUILDING OWNERS IN ACCORDANCE WITH STO'S WARRANTY PROGRAMS WHICH ARE SUBJECT TO CHANGE FROM TIME TO TIME. For the fullest, most current information on proper application, clean-up, mixing and other specifications and warranties, cautions and disclaimers, please refer to the Sto Corp. website, [www.stocorp.com](http://www.stocorp.com).

[www.stocorp.com](http://www.stocorp.com)



# StoPowerwall® DrainScreen™ Joint at Inside Corner: Different Substrates

Detail No.: 5.53a DS

Date: October 2014

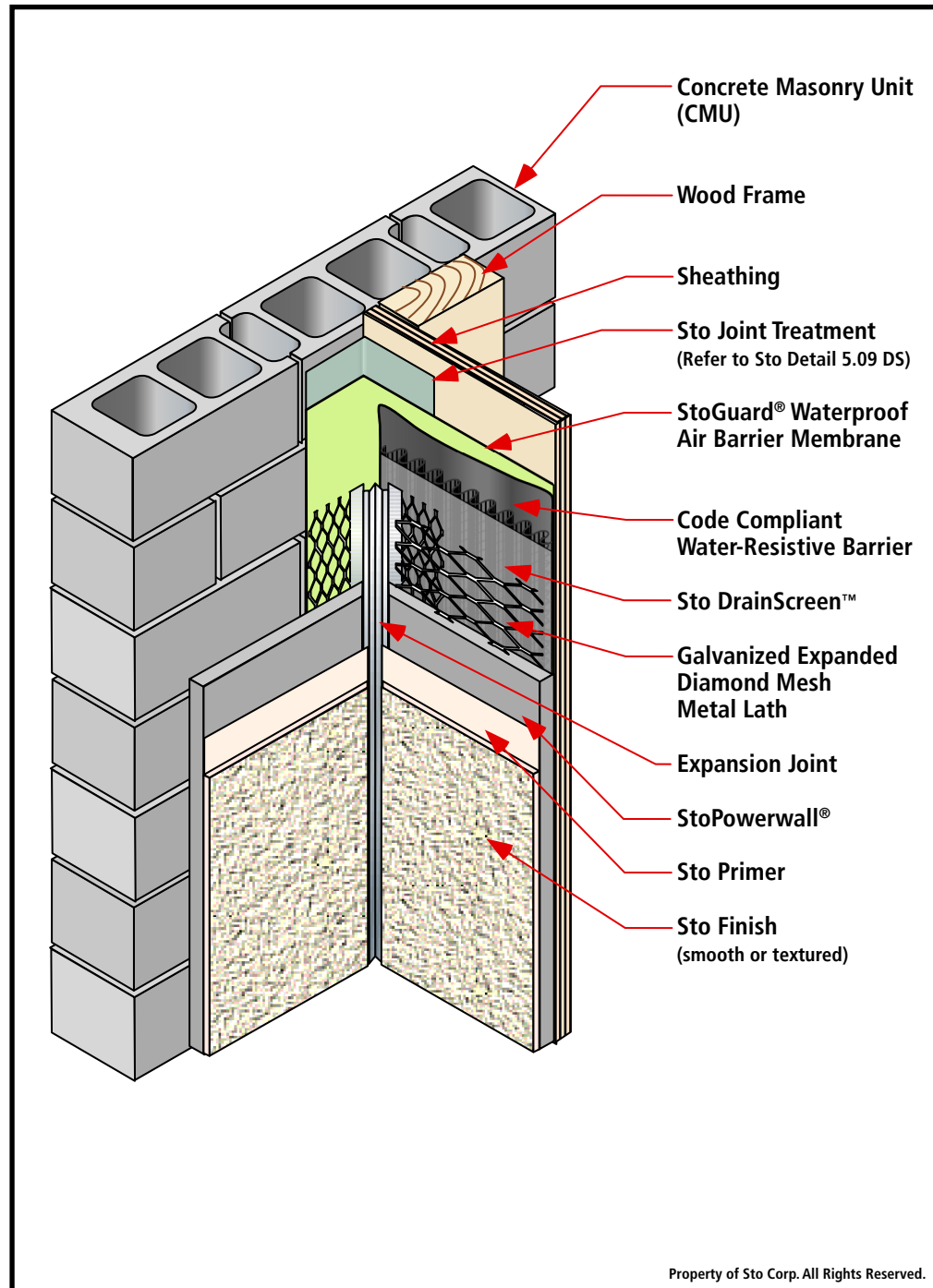

## Notes:

1. Wrap Sto joint treatment approximately 4" (200 mm) in each direction around the inside corner. Terminate the Sto joint treatment on the CMU side of the wall assembly so it coincides with the termination line of the accessory expanded flange.

## Options:

StoGuard® Waterproof Air Barrier Membrane options:

- a. Sto EmeraldCoat® (high perm)
- b. StoGuard® VaporSeal™ (vapor impermeable).

IMPORTANT: Components not identified as Sto are furnished by other manufacturers and are not necessarily installed by trades who install the Sto products. Refer to project specific contract documents.

## ATTENTION

Sto products are intended for use by qualified professional contractors, not consumers, as a component of a larger construction assembly as specified by a qualified design professional, general contractor or builder. They should be installed in accordance with those specifications and Sto's instructions. Sto Corp. disclaims all, and assumes no, liability for on-site inspections, for its products applied improperly, or by unqualified persons or entities, or as part of an improperly designed or constructed building, for the nonperformance of adjacent building components or assemblies, or for other construction activities beyond Sto's control. Improper use of Sto products or use as part of an improperly designed or constructed larger assembly or building may result in serious damage to Sto products, and to the structure of the building or its components.

STO CORP. DISCLAIMS ALL WARRANTIES EXPRESSED OR IMPLIED EXCEPT FOR EXPLICIT LIMITED WRITTEN WARRANTIES ISSUED TO AND ACCEPTED BY BUILDING OWNERS IN ACCORDANCE WITH STO'S WARRANTY PROGRAMS WHICH ARE SUBJECT TO CHANGE FROM TIME TO TIME. For the fullest, most current information on proper application, clean-up, mixing and other specifications and warranties, cautions and disclaimers, please refer to the Sto Corp. website, [www.stocorp.com](http://www.stocorp.com).

[www.stocorp.com](http://www.stocorp.com)

# StoPowerwall® DrainScreen™ Joint at Inside Corner: Common Substrate

Detail No.: 5.53b DS

Date: October 2014

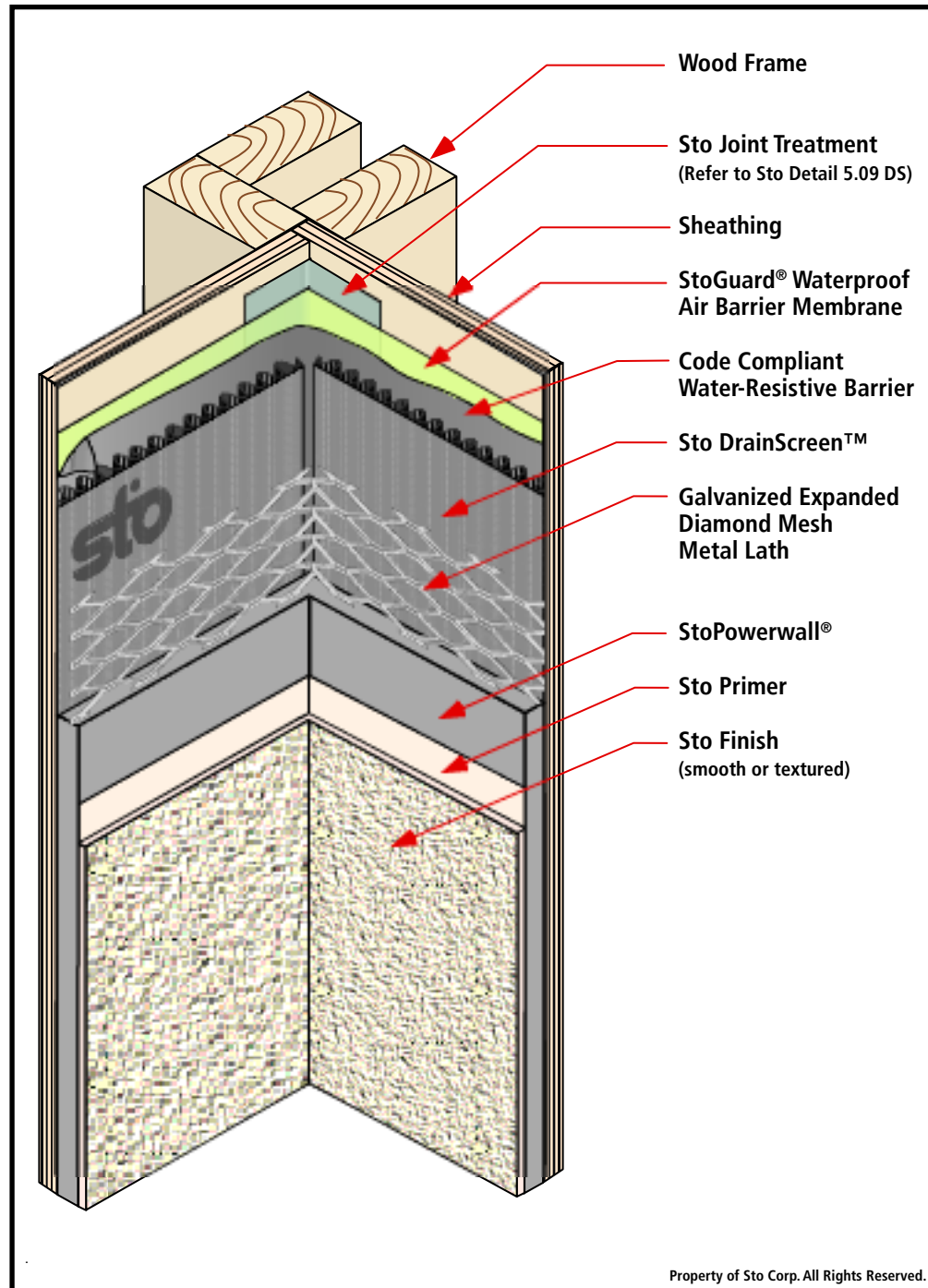

## Notes:

1. Install Sto joint treatment around inside corner. Coat entire surface with StoGuard® Waterproof Air Barrier Membrane
2. Bend lath at inside corner and extend past corner minimum 24" (610mm) in both directions or use corner lath over abutted metal lath. Fasten securely at the corner.

## Options:

StoGuard® Waterproof Air Barrier Membrane options:

- a. Sto EmeraldCoat®  
(high perm)
- b. StoGuard® VaporSeal™  
(vapor impermeable)

IMPORTANT: Components not identified as Sto are furnished by other manufacturers and are not necessarily installed by trades who install the Sto products. Refer to project specific contract documents.

## ATTENTION

Sto products are intended for use by qualified professional contractors, not consumers, as a component of a larger construction assembly as specified by a qualified design professional, general contractor or builder. They should be installed in accordance with those specifications and Sto's instructions. Sto Corp. disclaims all, and assumes no, liability for on-site inspections, for its products applied improperly, or by unqualified persons or entities, or as part of an improperly designed or constructed building, for the nonperformance of adjacent building components or assemblies, or for other construction activities beyond Sto's control. Improper use of Sto products or use as part of an improperly designed or constructed larger assembly or building may result in serious damage to Sto products, and to the structure of the building or its components.

STO CORP. DISCLAIMS ALL WARRANTIES EXPRESSED OR IMPLIED EXCEPT FOR EXPLICIT LIMITED WRITTEN WARRANTIES ISSUED TO AND ACCEPTED BY BUILDING OWNERS IN ACCORDANCE WITH STO'S WARRANTY PROGRAMS WHICH ARE SUBJECT TO CHANGE FROM TIME TO TIME. For the fullest, most current information on proper application, clean-up, mixing and other specifications and warranties, cautions and disclaimers, please refer to the Sto Corp. website, [www.stocorp.com](http://www.stocorp.com).

[www.stocorp.com](http://www.stocorp.com)

# StoPowerwall® DrainScreen™ Outside Corner

Detail No.: 5.54 DS

Date: October 2014

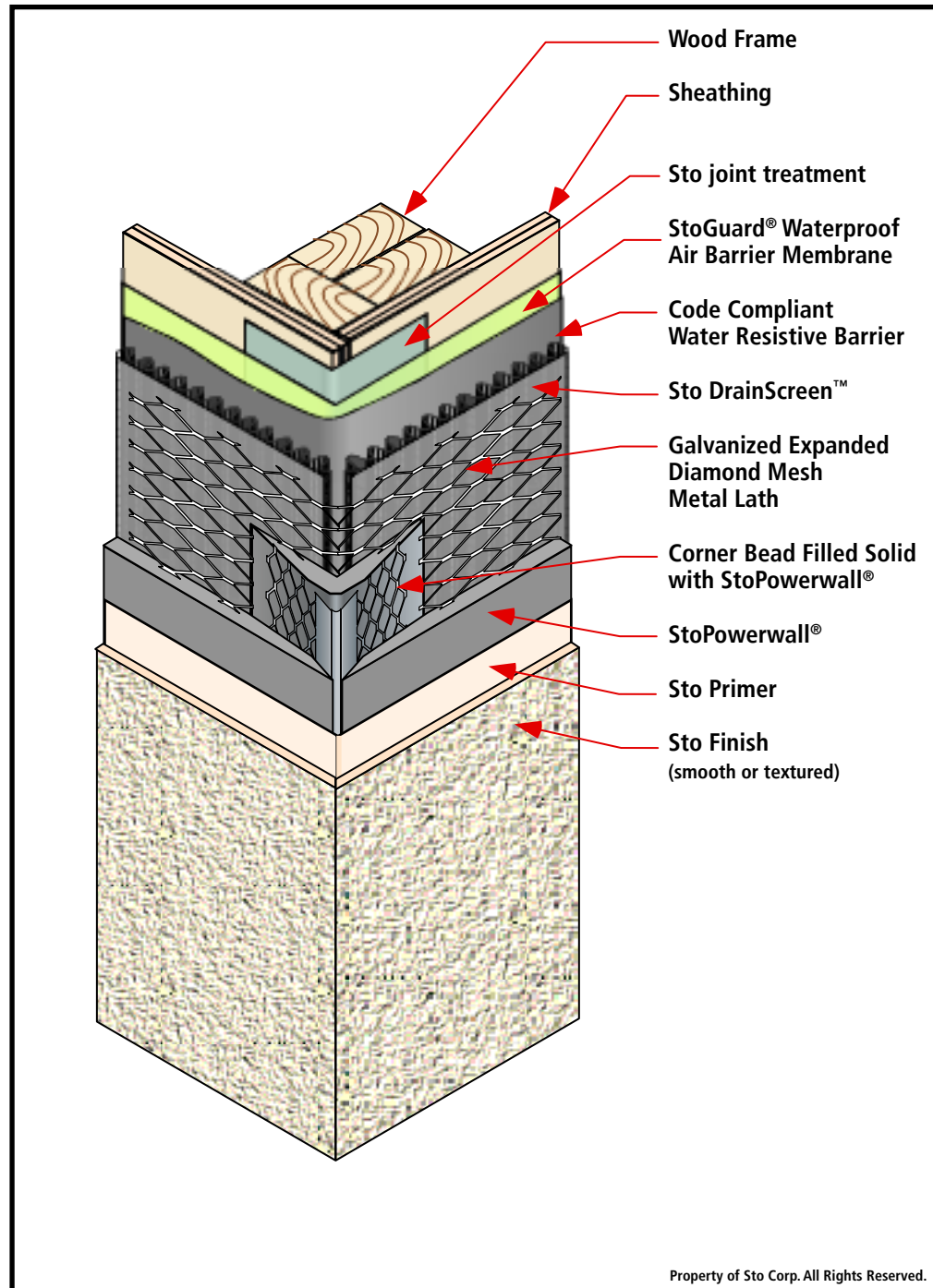

## Notes:

1. Install Sto Joint Treatment around sheathing joint at the outside corner.  
(See Sto Detail 5.09 DS)
2. Install galvanized expanded diamond mesh metal lath continuous around corner without break for minimum 24" (610mm).
3. Attach corner bead over lath.
4. Metal accessories are susceptible to corrosion in coastal environments. Metal corner beads with solid metal noses are susceptible to corrosion in exposed exterior applications.

## Options:

StoGuard® Waterproof Air Barrier Membrane options:

- a. Sto EmeraldCoat® (high perm)
- b. StoGuard® VaporSeal™ (vapor impermeable).

IMPORTANT: Components not identified as Sto are furnished by other manufacturers and are not necessarily installed by trades who install the Sto products. Refer to project specific contract documents.

## ATTENTION

Sto products are intended for use by qualified professional contractors, not consumers, as a component of a larger construction assembly as specified by a qualified design professional, general contractor or builder. They should be installed in accordance with those specifications and Sto's instructions. Sto Corp. disclaims all, and assumes no, liability for on-site inspections, for its products applied improperly, or by unqualified persons or entities, or as part of an improperly designed or constructed building, for the nonperformance of adjacent building components or assemblies, or for other construction activities beyond Sto's control. Improper use of Sto products or use as part of an improperly designed or constructed larger assembly or building may result in serious damage to Sto products, and to the structure of the building or its components.

STO CORP. DISCLAIMS ALL WARRANTIES EXPRESSED OR IMPLIED EXCEPT FOR EXPLICIT LIMITED WRITTEN WARRANTIES ISSUED TO AND ACCEPTED BY BUILDING OWNERS IN ACCORDANCE WITH STO'S WARRANTY PROGRAMS WHICH ARE SUBJECT TO CHANGE FROM TIME TO TIME. For the fullest, most current information on proper application, clean-up, mixing and other specifications and warranties, cautions and disclaimers, please refer to the Sto Corp. website, [www.stocorp.com](http://www.stocorp.com).

[www.stocorp.com](http://www.stocorp.com)

# StoPowerwall® DrainScreen™ Roof/Wall Diverter Flashing

Detail No.: 5.62 DS

Date: October 2014

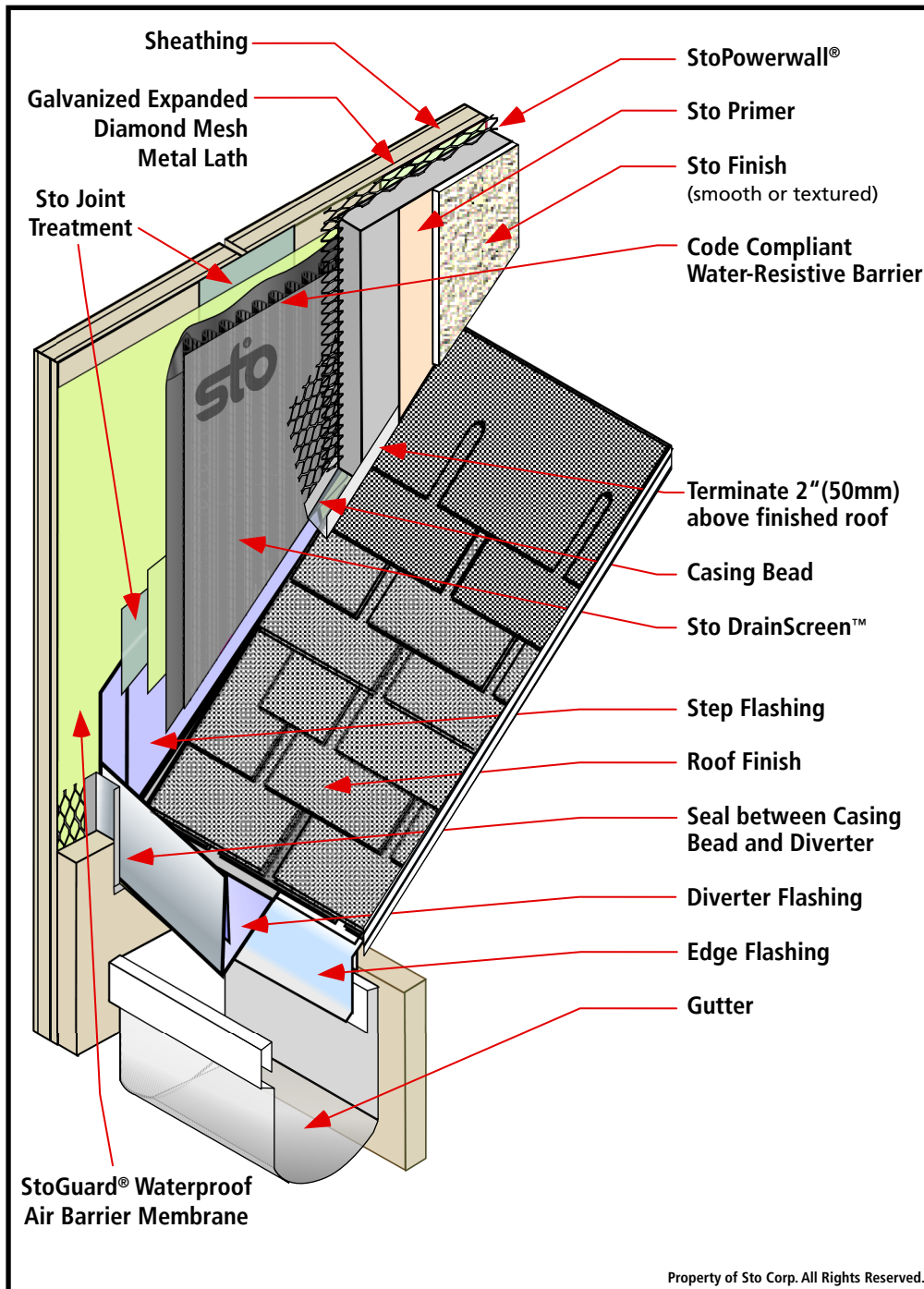

## Notes:

1. Install StoGuard® prior to installation of flashing.
2. Provide step flashing minimum 4" (100mm) extending up the wall.
3. Provide StoPowerwall® overlap of the step flashing 2" (50mm) and terminate StoPowerwall® a minimum of 2" (50mm) above the finished roof. The space permits re-roofing at a future date and helps prevent debris from accumulating between roof and StoPowerwall®
4. Terminate the step flashing with a water-tight Diverter (kick-out) Flashing to direct water into the gutter

Refer to Sto Detail 2.62b on fabrication of the Diverter Flashing.

5. Provide a 3/8" (10mm) joint around the Diverter Flashing and Seal

## Options:

StoGuard® Waterproof Air Barrier Membrane options:

- a. Sto EmeraldCoat® (high perm)
- b. StoGuard® VaporSeal™ (vapor impermeable)

IMPORTANT: Components not identified as Sto are furnished by other manufacturers and are not necessarily installed by trades who install the Sto products. Refer to project specific contract documents.

Property of Sto Corp. All Rights Reserved.

[www.stocorp.com](http://www.stocorp.com)

## ATTENTION

Sto products are intended for use by qualified professional contractors, not consumers, as a component of a larger construction assembly as specified by a qualified design professional, general contractor or builder. They should be installed in accordance with those specifications and Sto's instructions. Sto Corp. disclaims all, and assumes no, liability for on-site inspections, for its products applied improperly, or by unqualified persons or entities, or as part of an improperly designed or constructed building, for the nonperformance of adjacent building components or assemblies, or for other construction activities beyond Sto's control. Improper use of Sto products or use as part of an improperly designed or constructed larger assembly or building may result in serious damage to Sto products, and to the structure of the building or its components.

STO CORP. DISCLAIMS ALL WARRANTIES EXPRESSED OR IMPLIED EXCEPT FOR EXPLICIT LIMITED WRITTEN WARRANTIES ISSUED TO AND ACCEPTED BY BUILDING OWNERS IN ACCORDANCE WITH STO'S WARRANTY PROGRAMS WHICH ARE SUBJECT TO CHANGE FROM TIME TO TIME. For the fullest, most current information on proper application, clean-up, mixing and other specifications and warranties, cautions and disclaimers, please refer to the Sto Corp. website, [www.stocorp.com](http://www.stocorp.com).



# StoPowerwall® DrainScreen™ Saddle Flashing

Detail No.: 5.65 DS

Date: October 2014

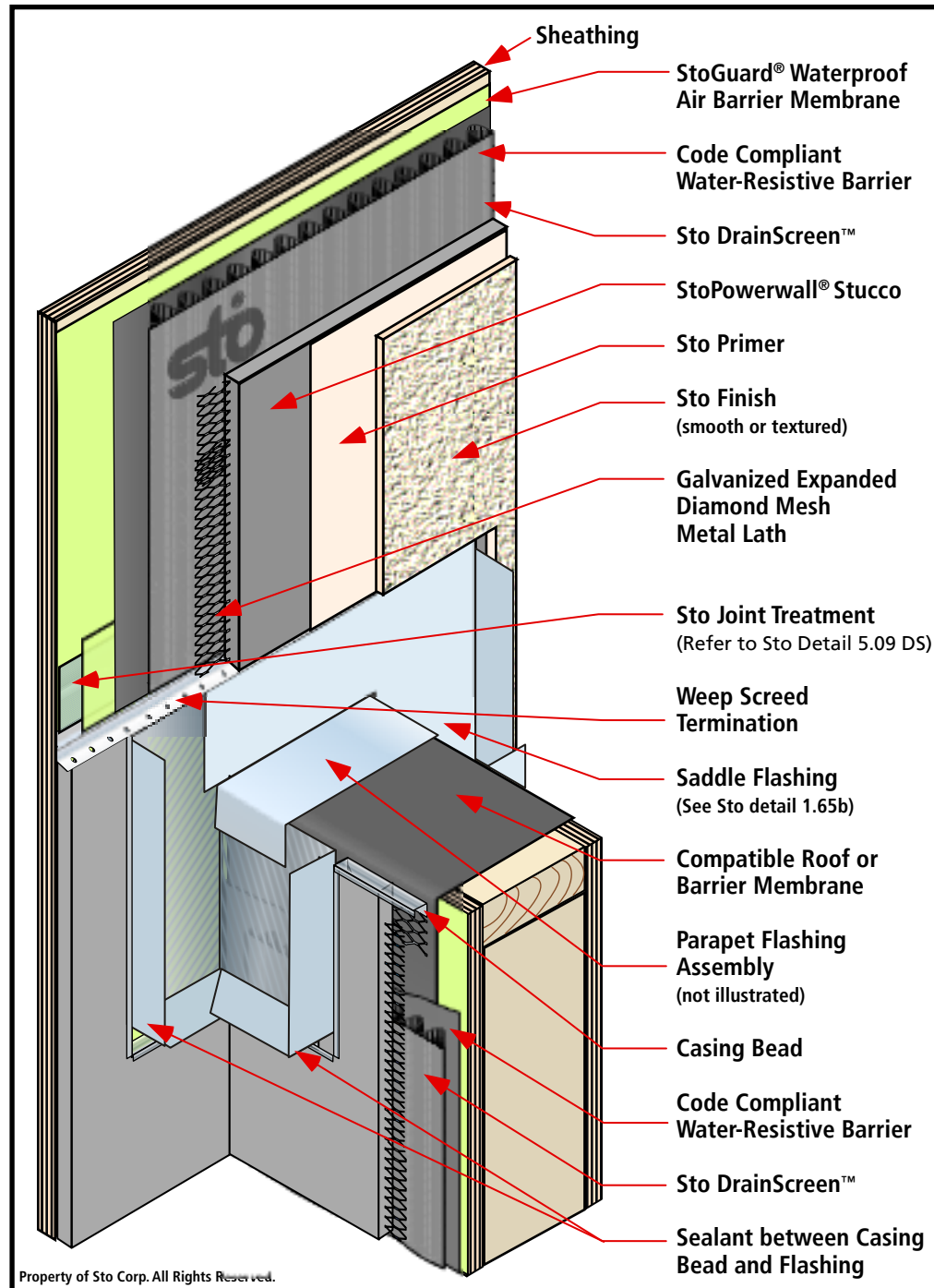

## Notes:

1. Install StoGuard® waterproof air barrier membrane behind flashing assembly integrated with compatible roof or barrier membrane over the Parapet.
2. Install saddle flashing assembly.  
(Refer to Sto Detail 1.65b for Assembly of Saddle Flashing.)
3. Install Sto joint treatment over the top of the saddle flashing and stucco weep screed termination.  
(Refer to Sto Detail 5.09 DS)
4. Lap StoPowerwall® over the flashing assembly at the top by a minimum of 2" (50mm) and terminate with 3/8" (10mm) joint around the perimeter.

## Options:

StoGuard® Waterproof Air Barrier Membrane options:

- a. Sto EmeraldCoat®  
(high perm)
- b. StoGuard® VaporSeal™  
(vapor impermeable).

IMPORTANT: Components not identified as Sto are furnished by other manufacturers and are not necessarily installed by trades who install the Sto products. Refer to project specific contract documents.

## ATTENTION

Sto products are intended for use by qualified professional contractors, not consumers, as a component of a larger construction assembly as specified by a qualified design professional, general contractor or builder. They should be installed in accordance with those specifications and Sto's instructions. Sto Corp. disclaims all, and assumes no, liability for on-site inspections, for its products applied improperly, or by unqualified persons or entities, or as part of an improperly designed or constructed building, for the nonperformance of adjacent building components or assemblies, or for other construction activities beyond Sto's control. Improper use of Sto products or use as part of an improperly designed or constructed larger assembly or building may result in serious damage to Sto products, and to the structure of the building or its components.

STO CORP. DISCLAIMS ALL WARRANTIES EXPRESSED OR IMPLIED EXCEPT FOR EXPLICIT LIMITED WRITTEN WARRANTIES ISSUED TO AND ACCEPTED BY BUILDING OWNERS IN ACCORDANCE WITH STO'S WARRANTY PROGRAMS WHICH ARE SUBJECT TO CHANGE FROM TIME TO TIME. For the fullest, most current information on proper application, clean-up, mixing and other specifications and warranties, cautions and disclaimers, please refer to the Sto Corp. website, [www.stocorp.com](http://www.stocorp.com).

[www.stocorp.com](http://www.stocorp.com)



# StoPowerwall® DrainScreen™ Foam Build-Outs

Detail No.: 5.70 DS

Date: October 2014

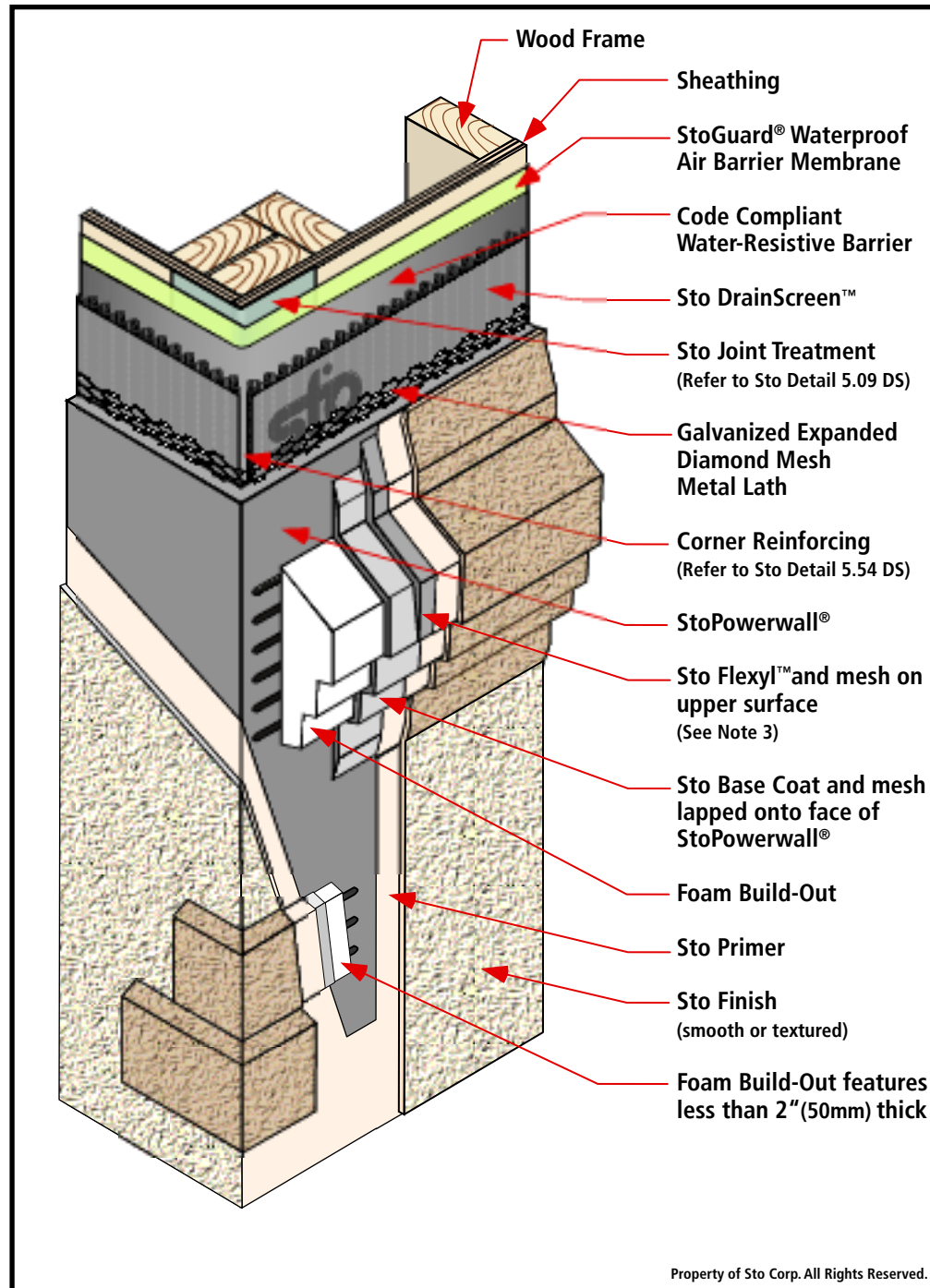

## Notes:

1. The maximum thickness of foam plastic insulation allowed by code is typically 4" (100 mm).
2. The exposed surface must have a minimum slope of 1:2 (27°). In locations where ice and snow may accumulate, increase slope.
3. Provide Sto Flexyl™ and mesh on upper surfaces of the foam build-out feature projecting more than 2" (50 mm) from the stucco surface.

## Options:

StoGuard® Waterproof Air Barrier Membrane options:

- a. Sto EmeraldCoat® (high perm)
- b. StoGuard® VaporSeal™ (vapor impermeable).

IMPORTANT: Components not identified as Sto are furnished by other manufacturers and are not necessarily installed by trades who install the Sto products. Refer to project specific contract documents.

## ATTENTION

Sto products are intended for use by qualified professional contractors, not consumers, as a component of a larger construction assembly as specified by a qualified design professional, general contractor or builder. They should be installed in accordance with those specifications and Sto's instructions. Sto Corp. disclaims all, and assumes no, liability for on-site inspections, for its products applied improperly, or by unqualified persons or entities, or as part of an improperly designed or constructed building, for the nonperformance of adjacent building components or assemblies, or for other construction activities beyond Sto's control. Improper use of Sto products or use as part of an improperly designed or constructed larger assembly or building may result in serious damage to Sto products, and to the structure of the building or its components.

STO CORP. DISCLAIMS ALL WARRANTIES EXPRESSED OR IMPLIED EXCEPT FOR EXPLICIT LIMITED WRITTEN WARRANTIES ISSUED TO AND ACCEPTED BY BUILDING OWNERS IN ACCORDANCE WITH STO'S WARRANTY PROGRAMS WHICH ARE SUBJECT TO CHANGE FROM TIME TO TIME. For the fullest, most current information on proper application, clean-up, mixing and other specifications and warranties, cautions and disclaimers, please refer to the Sto Corp. website, [www.stocorp.com](http://www.stocorp.com).

[www.stocorp.com](http://www.stocorp.com)